

C

3

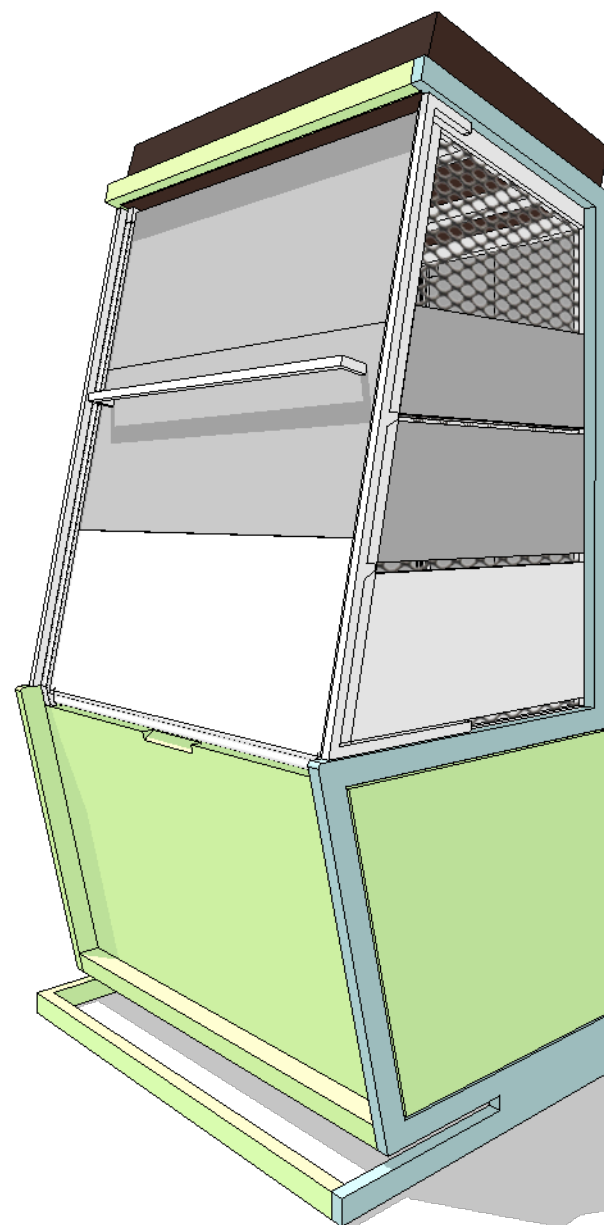

DESIGN C



THE COPYRIGHT OF THIS DRAWING REMAINS WITH THE LINK MANAGEMENT LIMITED.
NO PART OF THIS DRAWING MAY BE COPIED OR REPRODUCED IN ANY FORM OR BY ANY MEANS WITHOUT THE WRITTEN CONSENT OF THE LINK MANAGEMENT.

1. ALL DIMENSIONS ARE IN MILLIMETER.
2. ACTUAL DIMENSIONS TO BE CHECKED AND VERIFIED ON SITE.
3. THE CONTENT SHOWN IN THE DRAWINGS ARE FOR DESIGN INTENTION ONLY. THE CONTRACTOR SHOULD SUBMIT ALL NECESSARY INFORMATION INCLUDING SHOP DRAWING, MATERIAL SAMPLES OR CATALOGUES FOR APPROVAL PRIOR ANY CONSTRUCTION WORKS ON SITE.
4. ALL DIMENSIONS SHOWN IN THE DRAWINGS SHOULD BE SUBJECTED TO RE-MEASUREMENT / VERIFY ON SITE BY THE CONTRACTOR. SETTING OUT WORKS SHOULD BE APPROVED BY DESIGNER PRIOR CONSTRUCTION ON SITE.
5. IT IS THE RESPONSIBILITY OF THE CONTRACTOR TO SEEK CONFIRMATION OR CLARIFICATION ON ANY DISCREPANCY FOUND IN THE DRAWINGS / SPECIFICATIONS PRIOR CONSTRUCTION.
6. ALL ALTERNATIVE FINISHING MATERIALS SUBMITTED BY CONTRACTORS MUST BE APPROVED BY PROJECT MANAGER IN WRITING PRIOR TO PURCHASE OF ANY PRODUCTS.

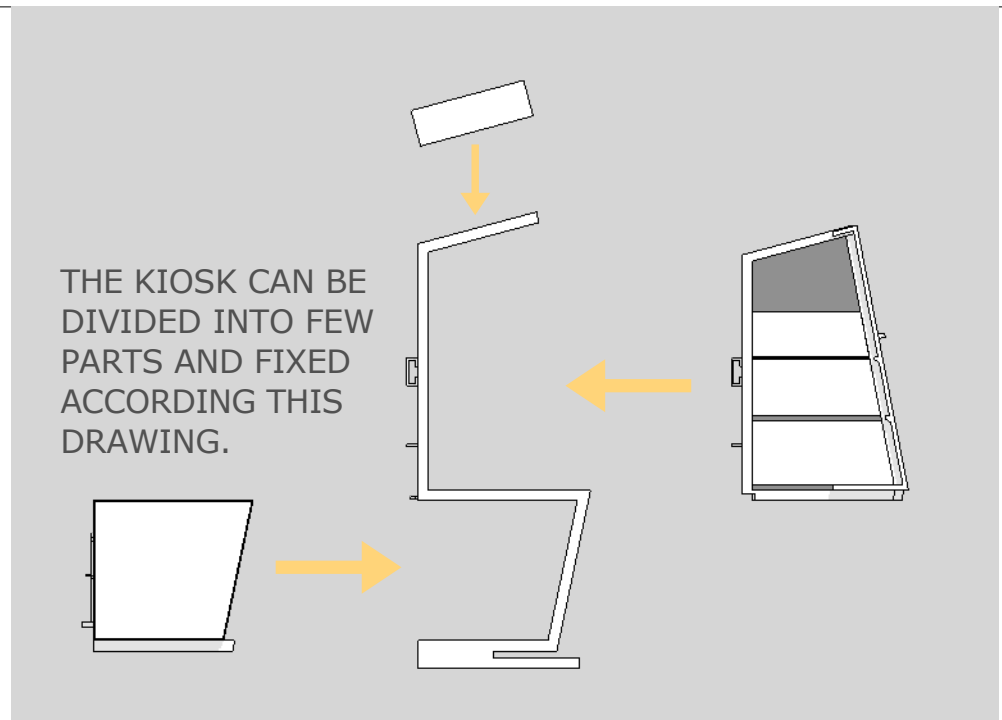
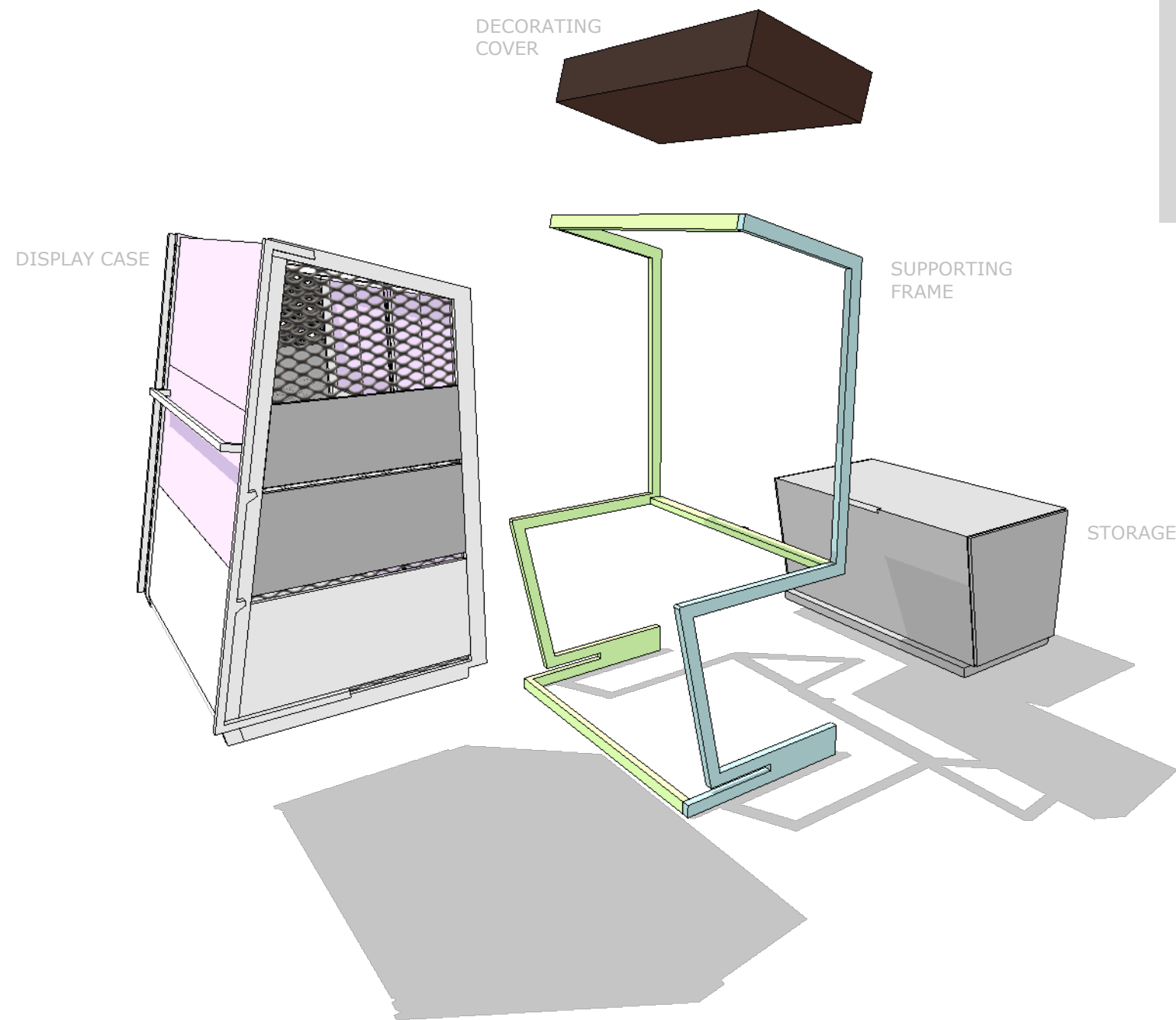

THE KIOSK CAN BE DIVIDED INTO FEW PARTS AND FIXED ACCORDING THIS DRAWING.

- NOTE:
1. THE PURPOSE OF THIS DRAWING IS TO SHOW THE COMPONENTS OF THE KIOSK.
 2. CONTRACTOR SHOULD SUBMIT THE FIXING DETAIL FOR APPROVAL.
 3. 2 TRACK LIGHT AND LED DECOR LIGHTS SHPILD BE PROVIDED FOR THE KIOSK, LOCATION TO BE CONFIRMED AFTER MOCK UP.
 4. ELECTRICAL PLUG IN SHOULD BE LOCATED AT THE BOTTOM OF KIOSK.
 5. ALL IRONMONGERY SHOULD BE STRONG ENOUGH WHEN THE KIOSK IS FULLY LOADED.
 6. ALL IRONMONGERY SHOULD BE STRONG ENOUGH AND DURABLE.

THE COPYRIGHT OF THIS DRAWING REMAINS WITH THE LINK MANAGEMENT LIMITED.
NO PART OF THIS DRAWING MAY BE COPIED OR REPRODUCED IN ANY FORM OR BY ANY MEANS WITHOUT THE WRITTEN CONSENT OF THE LINK MANAGEMENT.

1. ALL DIMENSIONS ARE IN MILLIMETER.
2. ACTUAL DIMENSIONS TO BE CHECKED AND VERIFIED ON SITE.
3. THE CONTENT SHOWN IN THE DRAWINGS ARE FOR DESIGN INTENTION ONLY. THE CONTRACTOR SHOULD SUBMIT ALL NECESSARY INFORMATION INCLUDING SHOP DRAWING, MATERIAL SAMPLES OR CATALOGUES FOR APPROVAL PRIOR ANY CONSTRUCTION WORKS ON SITE.
4. ALL DIMENSIONS SHOWN IN THE DRAWINGS SHOULD BE SUBJECTED TO RE-MEASUREMENT / VERIFY ON SITE BY THE CONTRACTOR. SETTING OUT WORKS SHOULD BE APPROVED BY DESIGNER PRIOR CONSTRUCTION ON SITE.
5. IT IS THE RESPONSIBILITY OF THE CONTRACTOR TO SEEK CONFIRMATION OR CLARIFICATION ON ANY DISCREPANCY FOUND IN THE DRAWINGS / SPECIFICATIONS PRIOR CONSTRUCTION.
6. ALL ALTERNATIVE FINISHING MATERIALS SUBMITTED BY CONTRACTORS MUST BE APPROVED BY PROJECT MANAGER IN WRITING PRIOR TO PURCHASE OF ANY PRODUCTS.

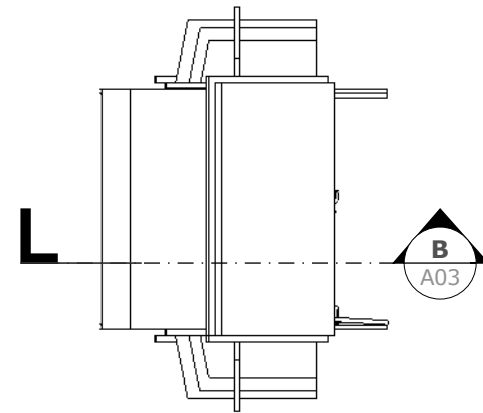
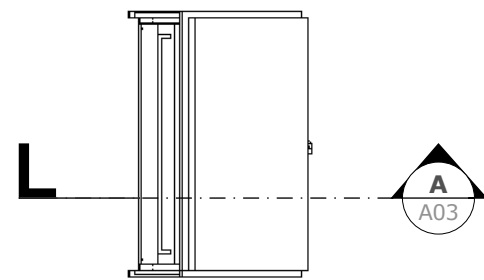

OPENING

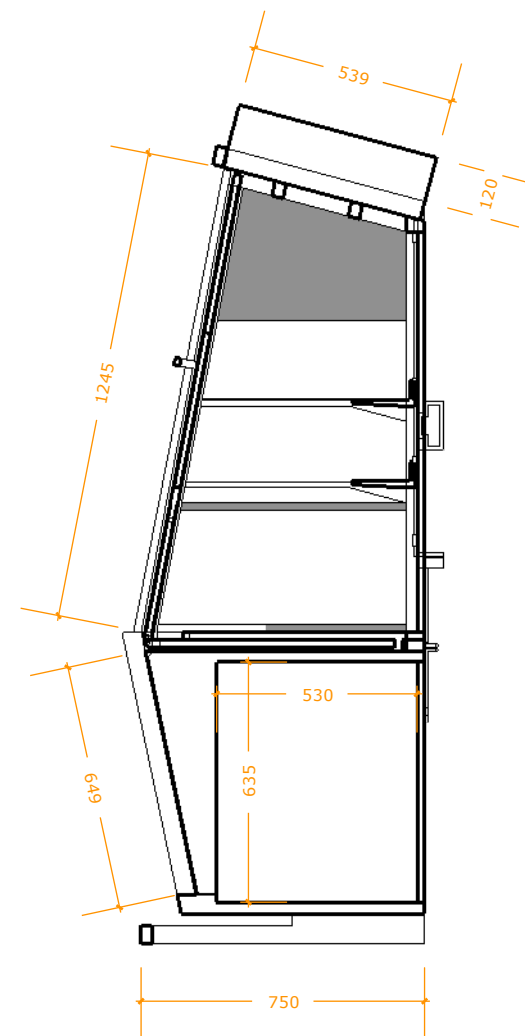

A :: SECTION
A03 scale: 1:20

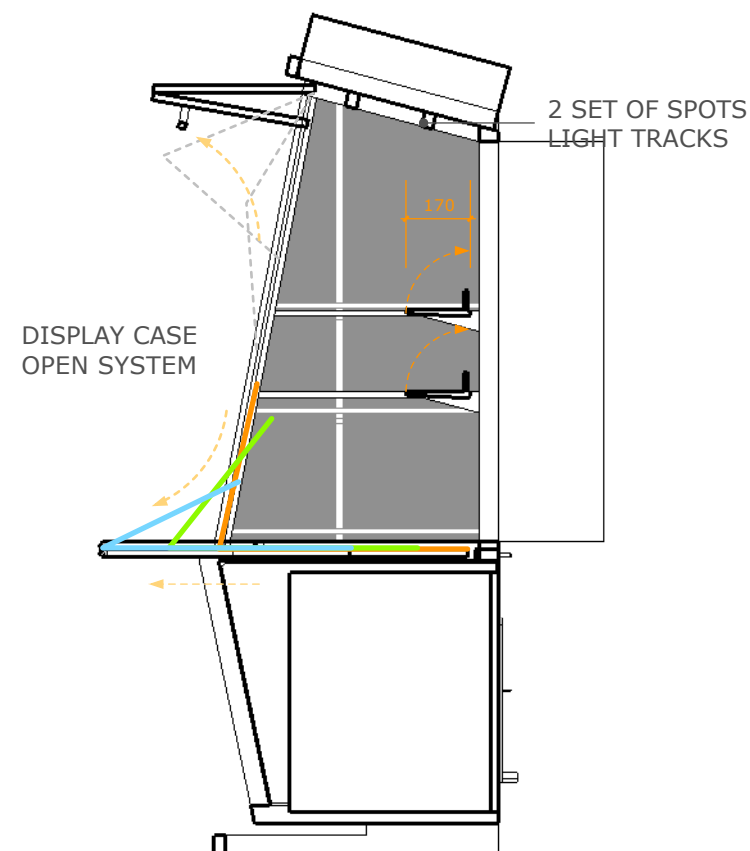

B :: SECTION
A03 scale: 1:20

LOCKING

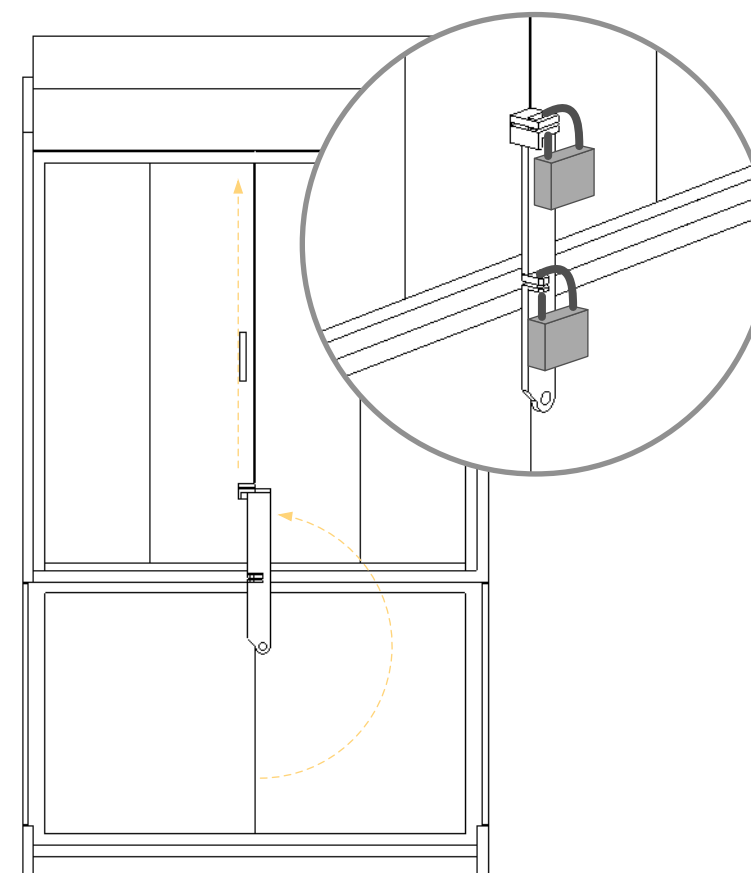

DETAIL DRAWING

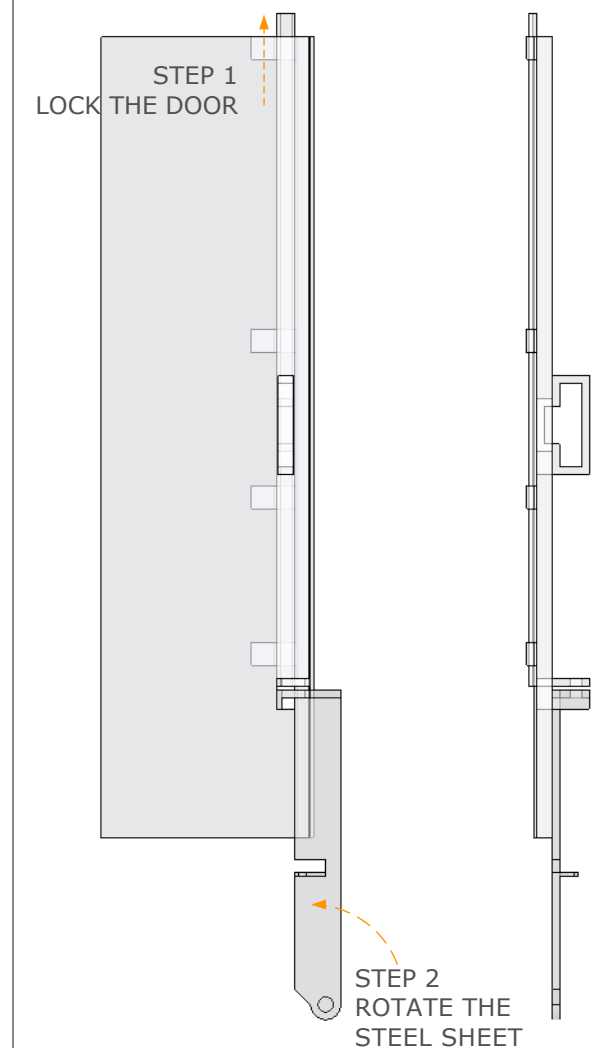

THE COPYRIGHT OF THIS DRAWING REMAINS WITH THE LINK MANAGEMENT LIMITED.
NO PART OF THIS DRAWING MAY BE COPIED OR REPRODUCED IN ANY FORM OR BY ANY MEANS WITHOUT THE WRITTEN CONSENT OF THE LINK MANAGEMENT.

1. ALL DIMENSIONS ARE IN MILLIMETER.
2. ACTUAL DIMENSIONS TO BE CHECKED AND VERIFIED ON SITE.
3. THE CONTENT SHOWN IN THE DRAWINGS ARE FOR DESIGN INTENTION ONLY. THE CONTRACTOR SHOULD SUBMIT ALL NECESSARY INFORMATION INCLUDING SHOP DRAWING, MATERIAL SAMPLES OR CATALOGUES FOR APPROVAL PRIOR ANY CONSTRUCTION WORKS ON SITE.
4. ALL DIMENSIONS SHOWN IN THE DRAWINGS SHOULD BE SUBJECTED TO RE-MEASUREMENT / VERIFY ON SITE BY THE CONTRACTOR. SETTING OUT WORKS SHOULD BE APPROVED BY DESIGNER PRIOR CONSTRUCTION ON SITE.
5. IT IS THE RESPONSIBILITY OF THE CONTRACTOR TO SEEK CONFIRMATION OR CLARIFICATION ON ANY DISCREPANCY FOUND IN THE DRAWINGS / SPECIFICATIONS PRIOR CONSTRUCTION.
6. ALL ALTERNATIVE FINISHING MATERIALS SUBMITTED BY CONTRACTORS MUST BE APPROVED BY PROJECT MANAGER IN WRITING PRIOR TO PURCHASE OF ANY PRODUCTS.

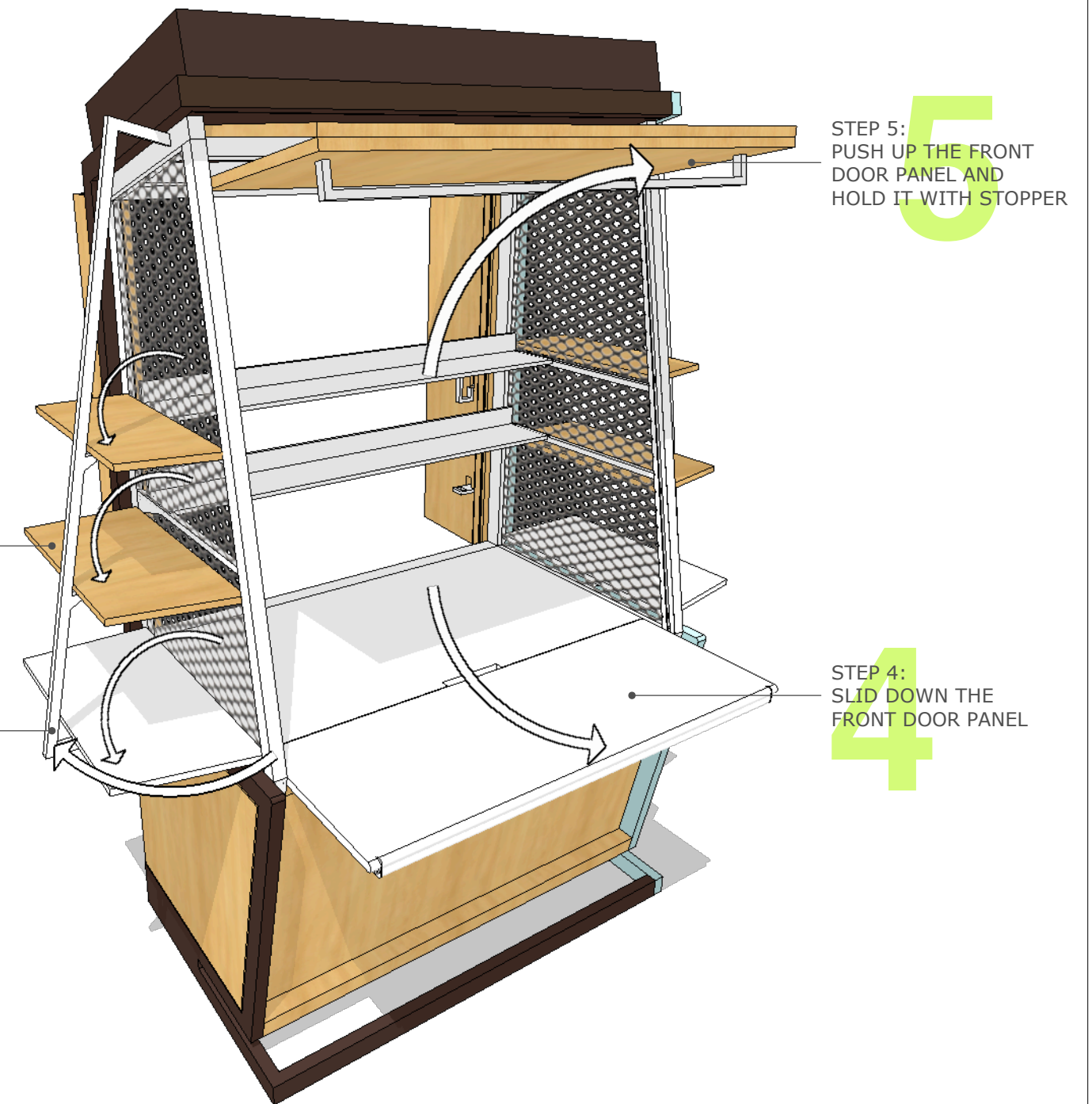
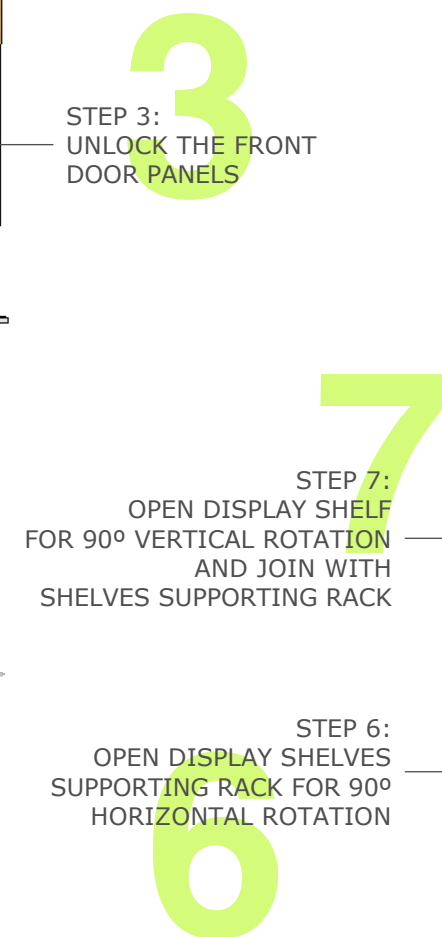
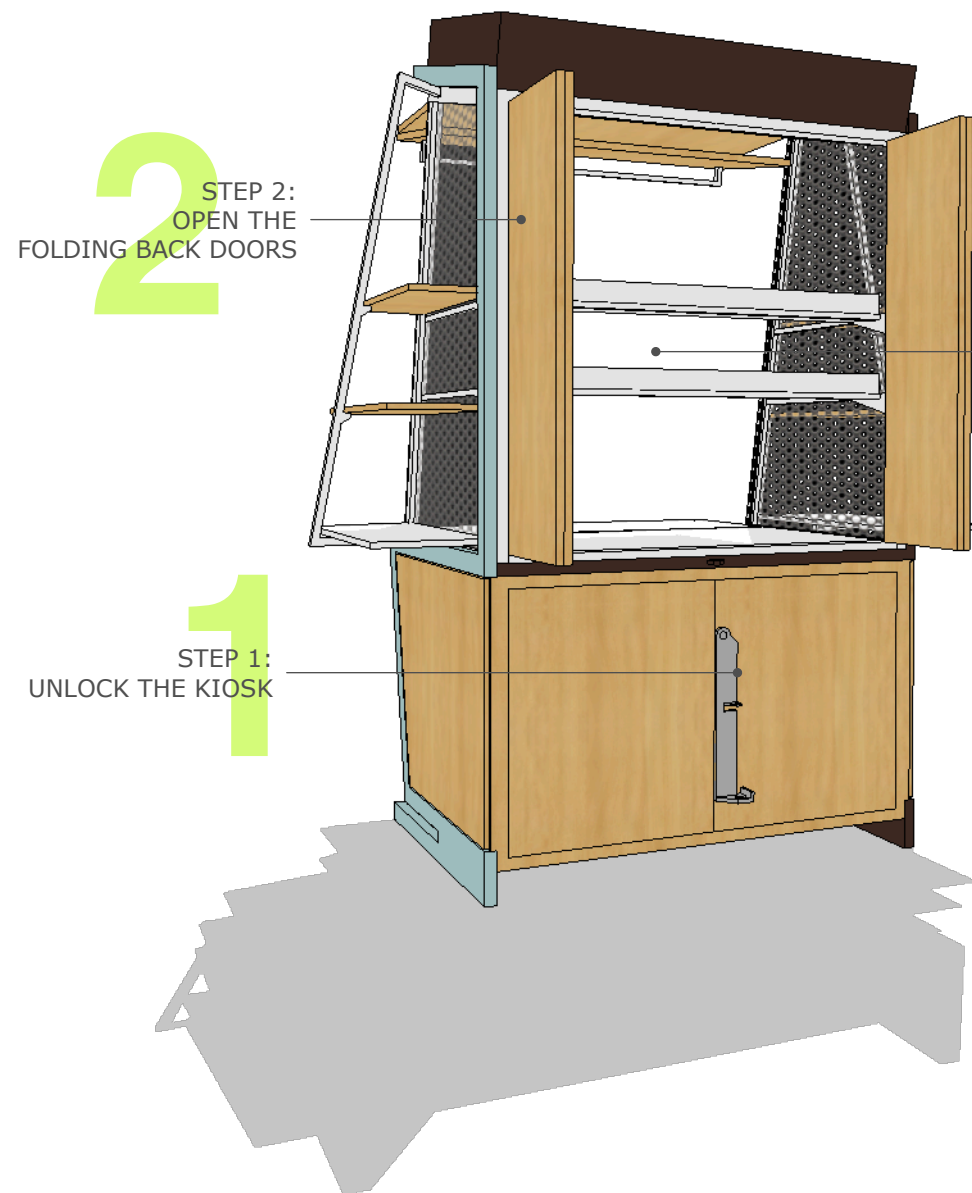

THE COPYRIGHT OF THIS DRAWING REMAINS WITH THE LINK MANAGEMENT LIMITED.
NO PART OF THIS DRAWING MAY BE COPIED OR REPRODUCED IN ANY FORM OR BY ANY MEANS WITHOUT THE
WRITTEN CONSENT OF THE LINK MANAGEMENT.

1. ALL DIMENSIONS ARE IN MILLIMETER.
2. ACTUAL DIMENSIONS TO BE CHECKED AND VERIFIED ON SITE.
3. THE CONTENT SHOWN IN THE DRAWINGS ARE FOR DESIGN INTENTION ONLY. THE CONTRACTOR SHOULD SUBMIT ALL NECESSARY INFORMATION INCLUDING SHOP DRAWING, MATERIAL SAMPLES OR CATALOGUES FOR APPROVAL PRIOR ANY CONSTRUCTION WORKS ON SITE.
4. ALL DIMENSIONS SHOWN IN THE DRAWINGS SHOULD BE SUBJECTED TO RE-MEASUREMENT / VERIFY ON SITE BY THE CONTRACTOR. SETTING OUT WORKS SHOULD BE APPROVED BY DESIGNER PRIOR CONSTRUCTION ON SITE.
5. IT IS THE RESPONSIBILITY OF THE CONTRACTOR TO SEEK CONFIRMATION OR CLARIFICATION ON ANY DISCREPANCY FOUND IN THE DRAWINGS / SPECIFICATIONS PRIOR CONSTRUCTION.
6. ALL ALTERNATIVE FINISHING MATERIALS SUBMITTED BY CONTRACTORS MUST BE APPROVED BY PROJECT MANAGER IN WRITING PRIOR TO PURCHASE OF ANY PRODUCTS.

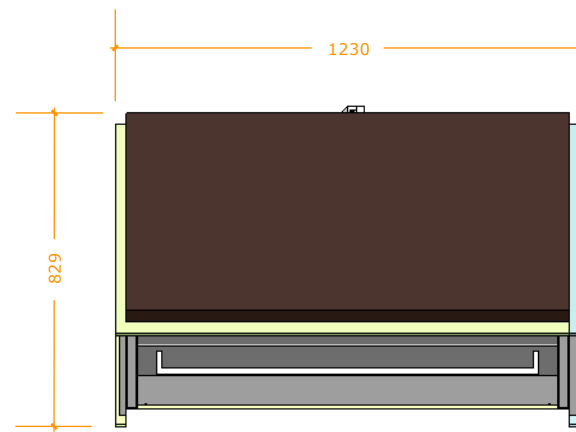

TOP VIEW

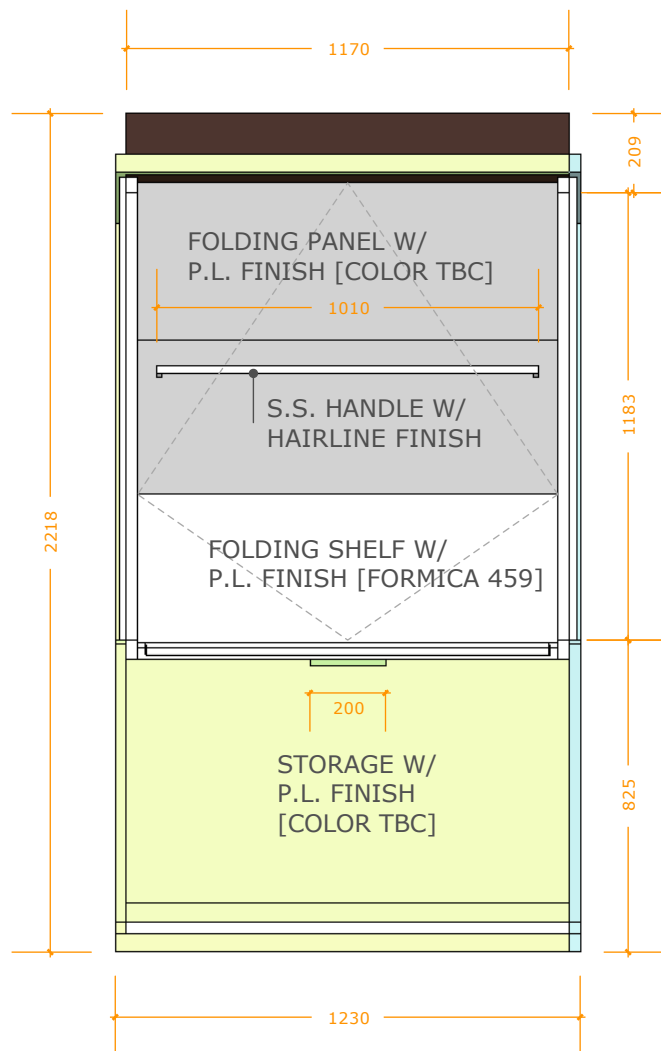

FRONT VIEW

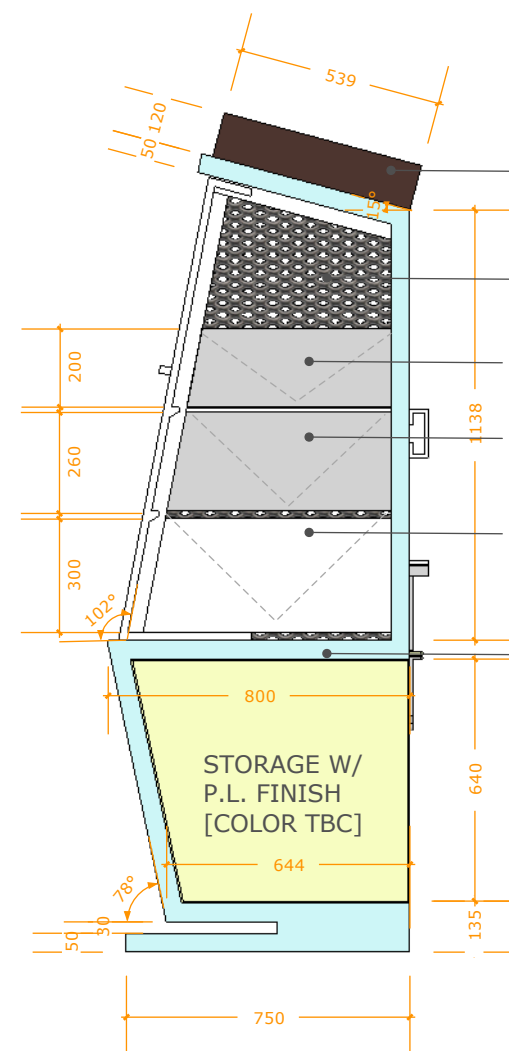

RIGHT VIEW

P.L. FINISH
[COLOR TBC]

S.S. MESH BOARD

FOLDING SHELF W/
P.L. FINISH [COLOR TBC]

FOLDING SHELF W/
P.L. FINISH [COLOR TBC]

FOLDING SHELF W/
P.L. FINISH [FORMICA 459]

STEEL FRAME W/
COLOR COATING
[COLOR TBC]

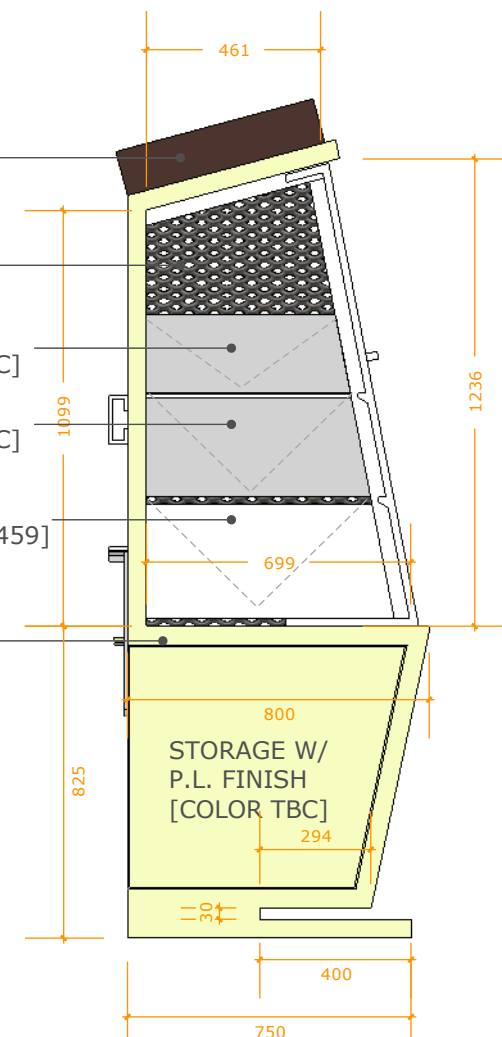

LEFT VIEW

WHEEL W/ STOPPER

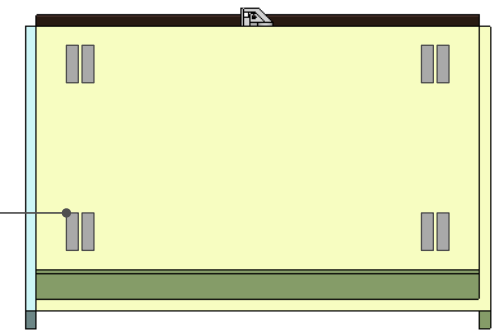

BOTTOM VIEW

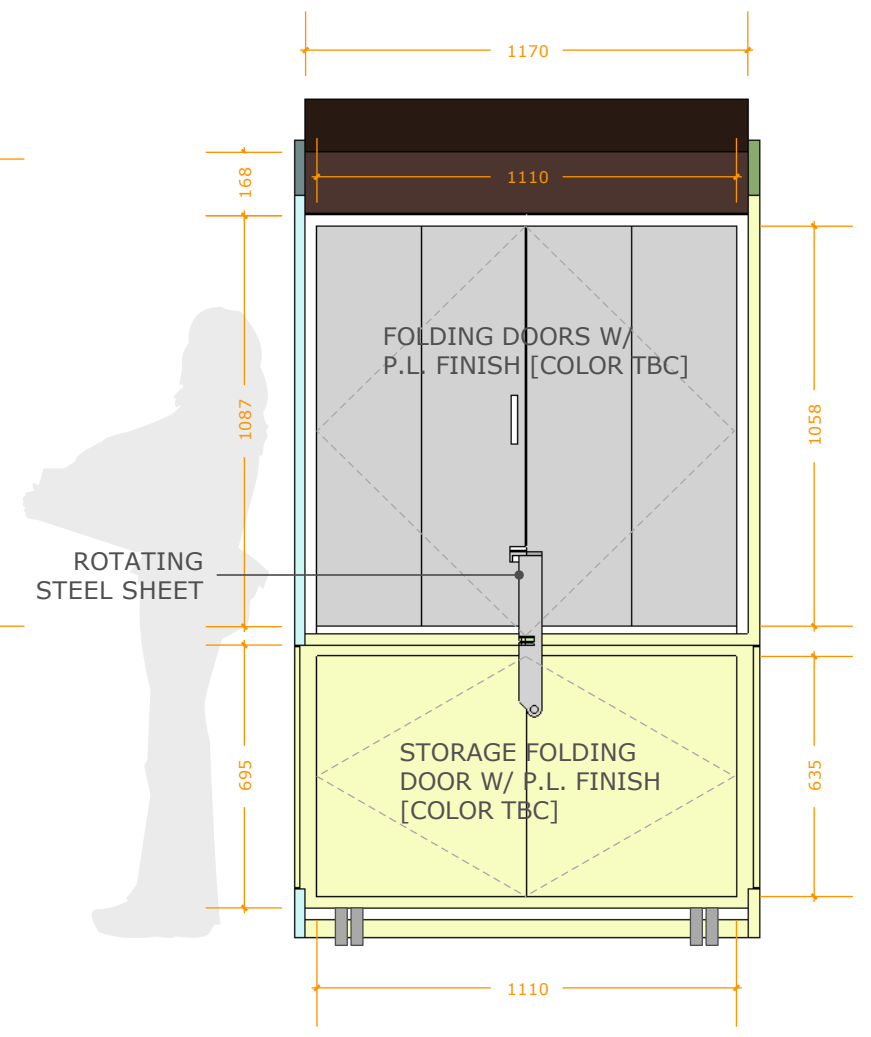

BACK VIEW

THE COPYRIGHT OF THIS DRAWING REMAINS WITH THE LINK MANAGEMENT LIMITED.
NO PART OF THIS DRAWING MAY BE COPIED OR REPRODUCED IN ANY FORM OR BY ANY MEANS WITHOUT THE WRITTEN CONSENT OF THE LINK MANAGEMENT.

1. ALL DIMENSIONS ARE IN MILLIMETER.
2. ACTUAL DIMENSIONS TO BE CHECKED AND VERIFIED ON SITE.
3. THE CONTENT SHOWN IN THE DRAWINGS ARE FOR DESIGN INTENTION ONLY. THE CONTRACTOR SHOULD SUBMIT ALL NECESSARY INFORMATION INCLUDING SHOP DRAWING, MATERIAL SAMPLES OR CATALOGUES FOR APPROVAL PRIOR ANY CONSTRUCTION WORKS ON SITE.
4. ALL DIMENSIONS SHOWN IN THE DRAWINGS SHOULD BE SUBJECT TO RE-MEASUREMENT / VERIFY ON SITE BY THE CONTRACTOR. SETTING OUT WORKS SHOULD BE APPROVED BY DESIGNER PRIOR CONSTRUCTION ON SITE.
5. IT IS THE RESPONSIBILITY OF THE CONTRACTOR TO SEEK CONFIRMATION OR CLARIFICATION ON ANY DISCREPANCY FOUND IN THE DRAWINGS / SPECIFICATIONS PRIOR CONSTRUCTION.
6. ALL ALTERNATIVE FINISHING MATERIALS SUBMITTED BY CONTRACTORS MUST BE APPROVED BY PROJECT MANAGER IN WRITING PRIOR TO PURCHASE OF ANY PRODUCTS.

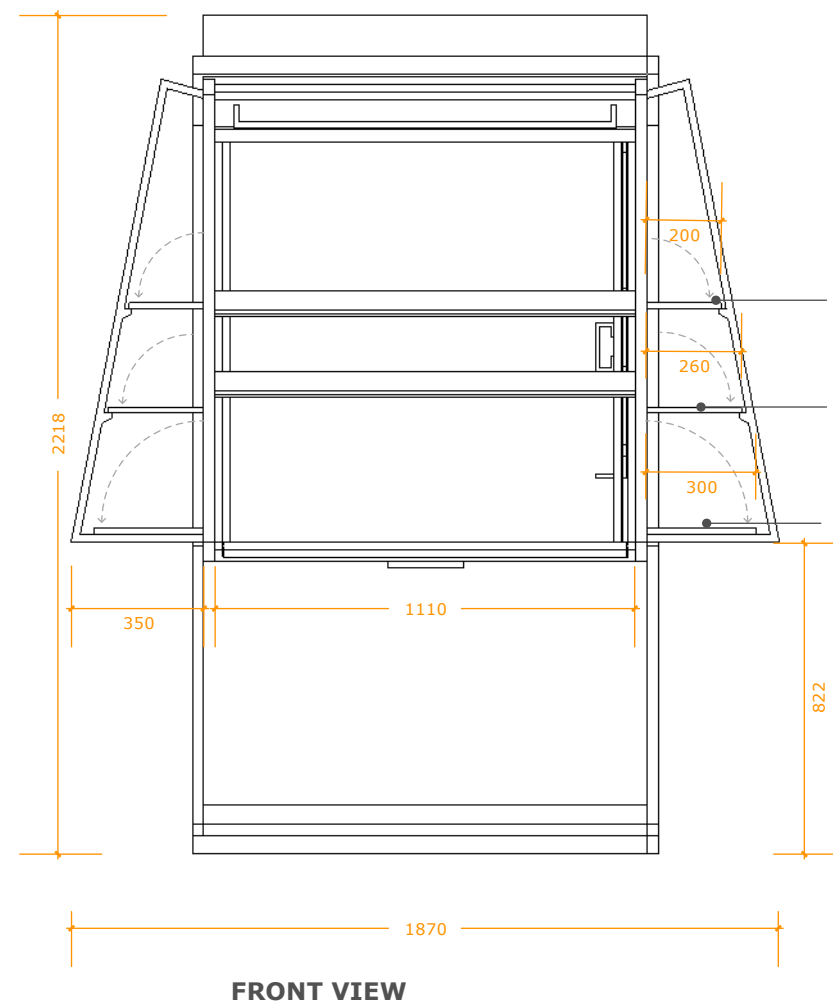
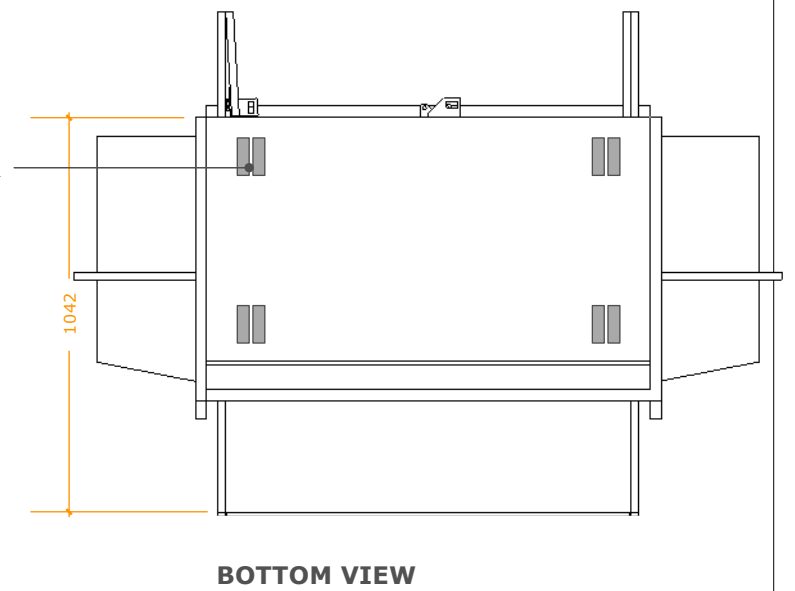
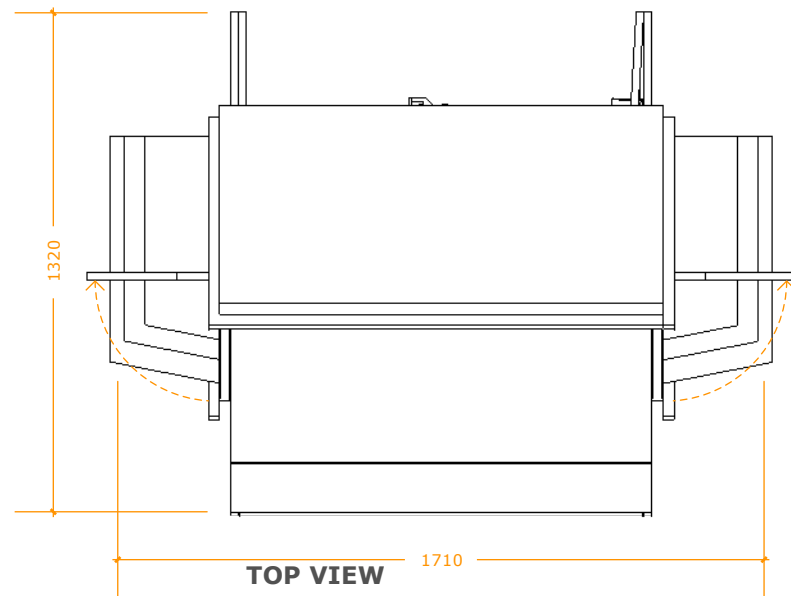

FOLDING SHELF W/
P.L. FINISH [COLOR TBC]

FOLDING SHELF W/
P.L. FINISH [COLOR TBC]

FOLDING SHELF W/
P.L. FINISH [FORMICA 459]

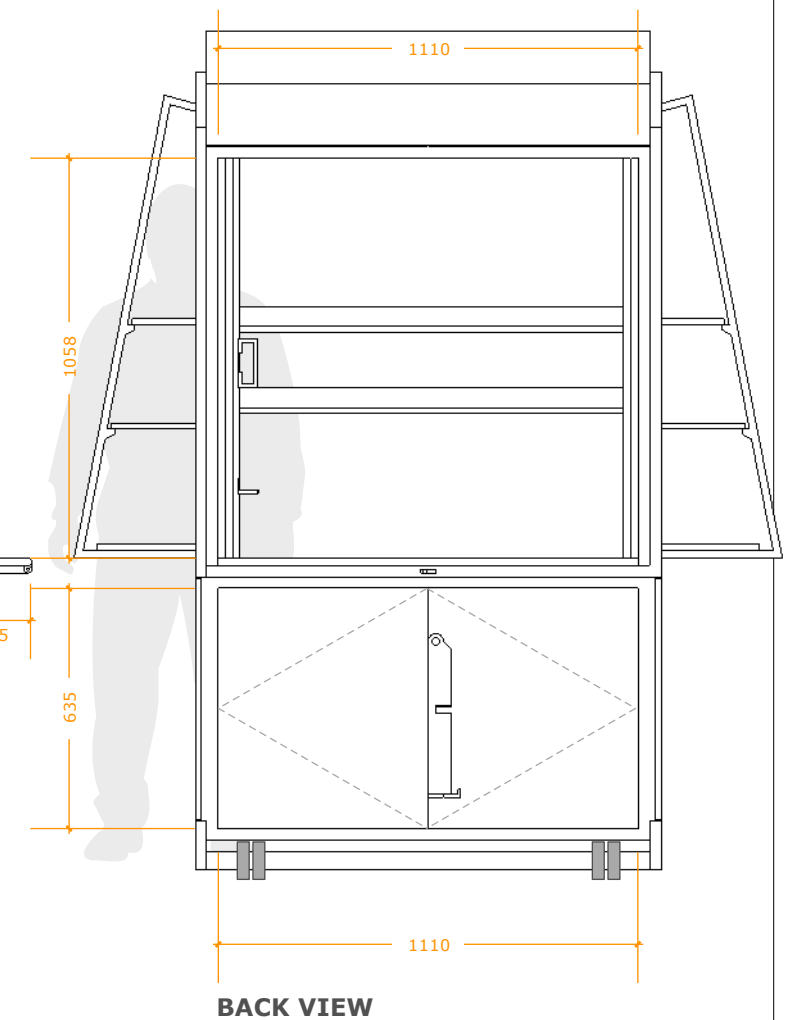
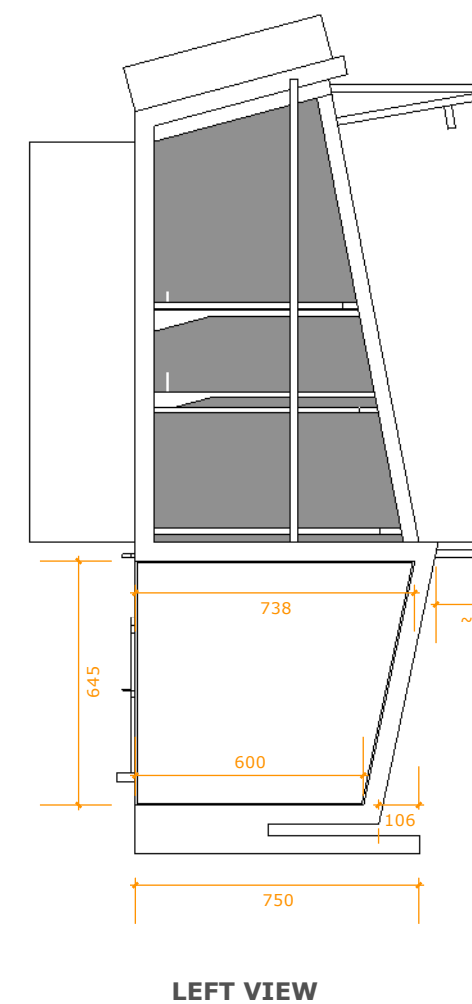
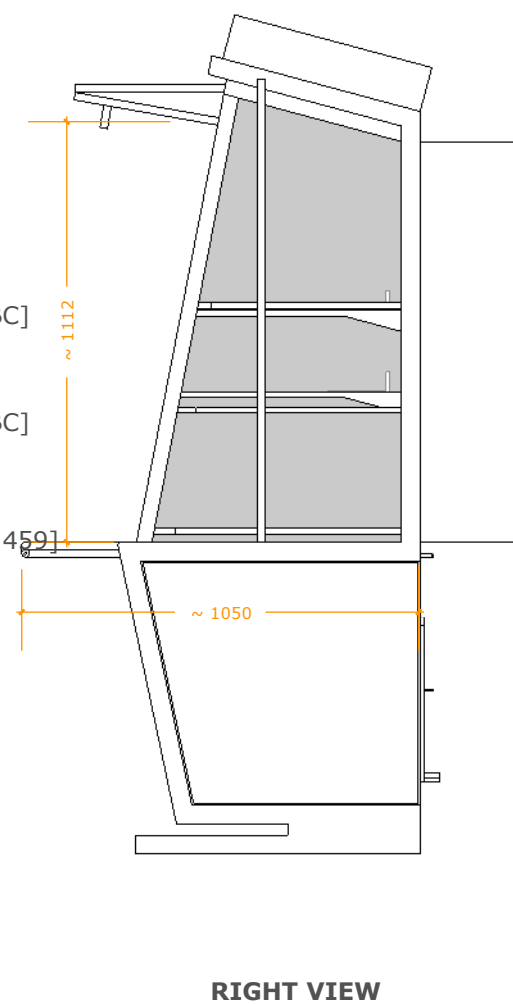

THE COPYRIGHT OF THIS DRAWING REMAINS WITH THE LINK MANAGEMENT LIMITED.
NO PART OF THIS DRAWING MAY BE COPIED OR REPRODUCED IN ANY FORM OR BY ANY MEANS WITHOUT THE WRITTEN CONSENT OF THE LINK MANAGEMENT.

1. ALL DIMENSIONS ARE IN MILLIMETER.
2. ACTUAL DIMENSIONS TO BE CHECKED AND VERIFIED ON SITE.
3. THE CONTENT SHOWN IN THE DRAWINGS ARE FOR DESIGN INTENTION ONLY. THE CONTRACTOR SHOULD SUBMIT ALL NECESSARY INFORMATION INCLUDING SHOP DRAWING, MATERIAL SAMPLES OR CATALOGUES FOR APPROVAL PRIOR ANY CONSTRUCTION WORKS ON SITE.
4. ALL DIMENSIONS SHOWN IN THE DRAWINGS SHOULD BE SUBJECTED TO RE-MEASUREMENT / VERIFY ON SITE BY THE CONTRACTOR. SETTING OUT WORKS SHOULD BE APPROVED BY DESIGNER PRIOR CONSTRUCTION ON SITE.
5. IT IS THE RESPONSIBILITY OF THE CONTRACTOR TO SEEK CONFIRMATION OR CLARIFICATION ON ANY DISCREPANCY FOUND IN THE DRAWINGS / SPECIFICATIONS PRIOR CONSTRUCTION.
6. ALL ALTERNATIVE FINISHING MATERIALS SUBMITTED BY CONTRACTORS MUST BE APPROVED BY PROJECT MANAGER IN WRITING PRIOR TO PURCHASE OF ANY PRODUCTS.