

A³

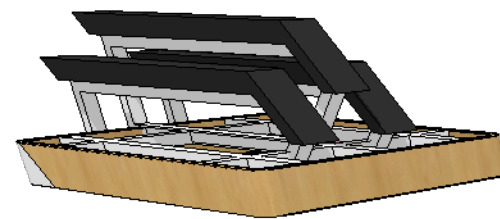

THE COPYRIGHT OF THIS DRAWING REMAINS WITH THE LINK MANAGEMENT LIMITED.
NO PART OF THIS DRAWING MAY BE COPIED OR REPRODUCED IN ANY FORM OR BY ANY MEANS WITHOUT THE WRITTEN CONSENT OF THE LINK MANAGEMENT.

1. ALL DIMENSIONS ARE IN MILLIMETER.
2. ACTUAL DIMENSIONS TO BE CHECKED AND VERIFIED ON SITE.
3. THE CONTENT SHOWN IN THE DRAWINGS ARE FOR DESIGN INTENTION ONLY. THE CONTRACTOR SHOULD SUBMIT ALL NECESSARY INFORMATION INCLUDING SHOP DRAWING, MATERIAL SAMPLES OR CATALOGUES FOR APPROVAL PRIOR ANY CONSTRUCTION WORKS ON SITE.
4. ALL DIMENSIONS SHOWN IN THE DRAWINGS SHOULD BE SUBJECTED TO RE-MEASUREMENT / VERIFY ON SITE BY THE CONTRACTOR. SETTING OUT WORKS SHOULD BE APPROVED BY DESIGNER PRIOR CONSTRUCTION ON SITE.
5. IT IS THE RESPONSIBILITY OF THE CONTRACTOR TO SEEK CONFIRMATION OR CLARIFICATION ON ANY DISCREPANCY FOUND IN THE DRAWINGS / SPECIFICATIONS PRIOR CONSTRUCTION.
6. ALL ALTERNATIVE FINISHING MATERIALS SUBMITTED BY CONTRACTORS MUST BE APPROVED BY PROJECT MANAGER IN WRITING PRIOR TO PURCHASE OF ANY PRODUCTS.



MOVABLE DECOR
TOP COVER

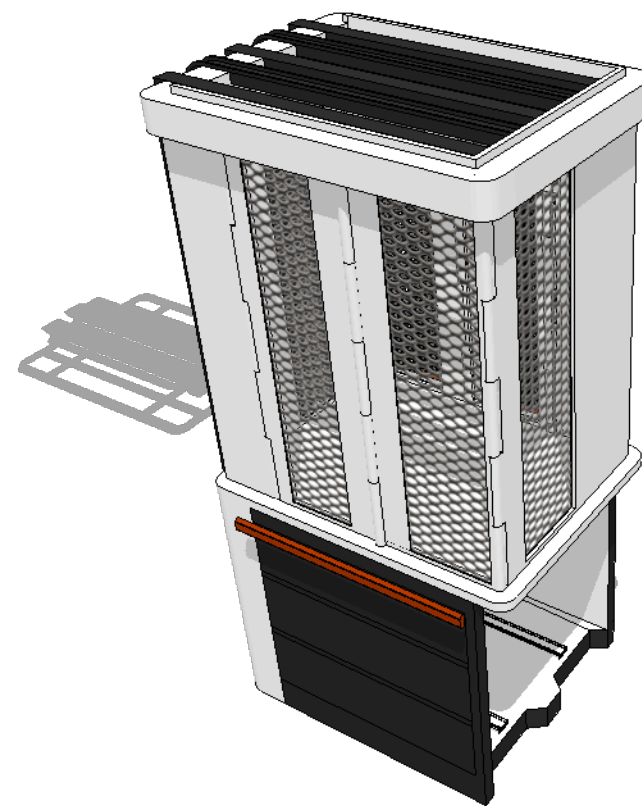

ORIGINAL
KIOSK

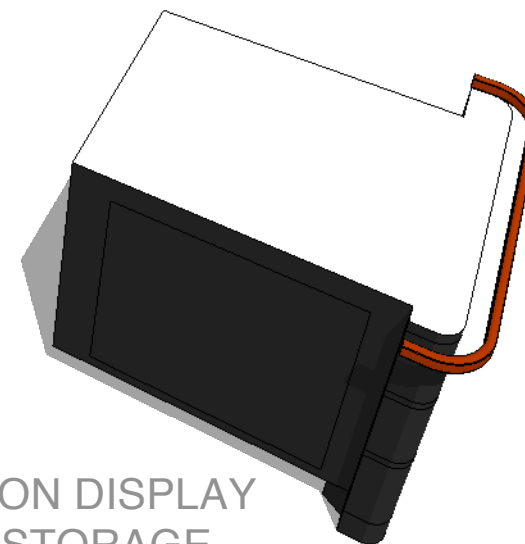

EXTENSION DISPLAY
TABLE & STORAGE

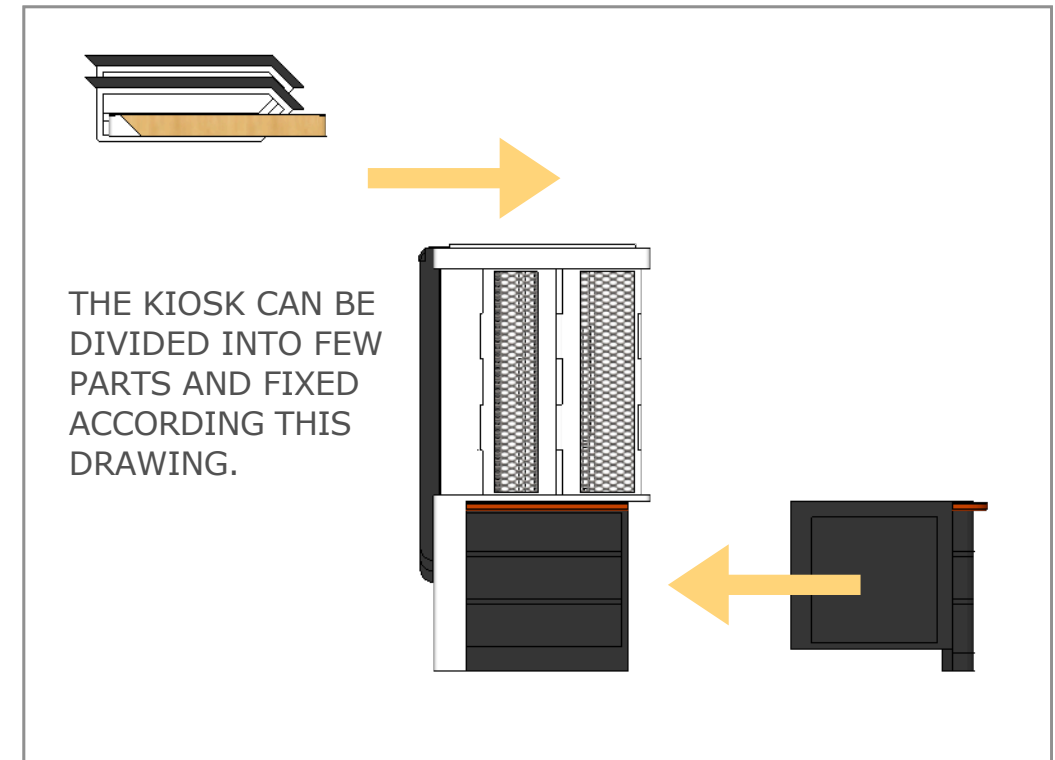

NOTE:

1. THE PURPOSE OF THIS DRAWING IS TO SHOW THE COMPONENTS OF THE KIOSK.
2. CONTRACTOR SHOULD SUBMIT THE FIXING DETAIL FOR APPROVAL.
3. 2 TRACK LIGHT AND LED DECOR LIGHTS SHPILD BE PROVIDED FOR THE KIOSK, LOCATION TO BE CONFIRMED AFTER MOCK UP.
4. ELECTRICAL PLUG IN SHOULD BE LOCATED AT THE BOTTOM OF KIOSK.
5. ALL IRONMONGERY SHOULD BE STRONG ENOUGH WHEN THE KIOSK IS FULLY LOADED.
6. ALL IRONMONGERY SHOULD BE STRONG ENOUGH AND DURABLE.

THE COPYRIGHT OF THIS DRAWING REMAINS WITH THE LINK MANAGEMENT LIMITED.
NO PART OF THIS DRAWING MAY BE COPIED OR REPRODUCED IN ANY FORM OR BY ANY MEANS WITHOUT THE WRITTEN CONSENT OF THE LINK MANAGEMENT.

1. ALL DIMENSIONS ARE IN MILLIMETER.
2. ACTUAL DIMENSIONS TO BE CHECKED AND VERIFIED ON SITE.
3. THE CONTENT SHOWN IN THE DRAWINGS ARE FOR DESIGN INTENTION ONLY. THE CONTRACTOR SHOULD SUBMIT ALL NECESSARY INFORMATION INCLUDING SHOP DRAWING, MATERIAL SAMPLES OR CATALOGUES FOR APPROVAL PRIOR ANY CONSTRUCTION WORKS ON SITE.
4. ALL DIMENSIONS SHOWN IN THE DRAWINGS SHOULD BE SUBJECTED TO RE-MEASUREMENT / VERIFY ON SITE BY THE CONTRACTOR. SETTING OUT WORKS SHOULD BE APPROVED BY DESIGNER PRIOR CONSTRUCTION ON SITE.
5. IT IS THE RESPONSIBILITY OF THE CONTRACTOR TO SEEK CONFIRMATION OR CLARIFICATION ON ANY DISCREPANCY FOUND IN THE DRAWINGS / SPECIFICATIONS PRIOR CONSTRUCTION.
6. ALL ALTERNATIVE FINISHING MATERIALS SUBMITTED BY CONTRACTORS MUST BE APPROVED BY PROJECT MANAGER IN WRITING PRIOR TO PURCHASE OF ANY PRODUCTS.

Transform

FOLDING CASE

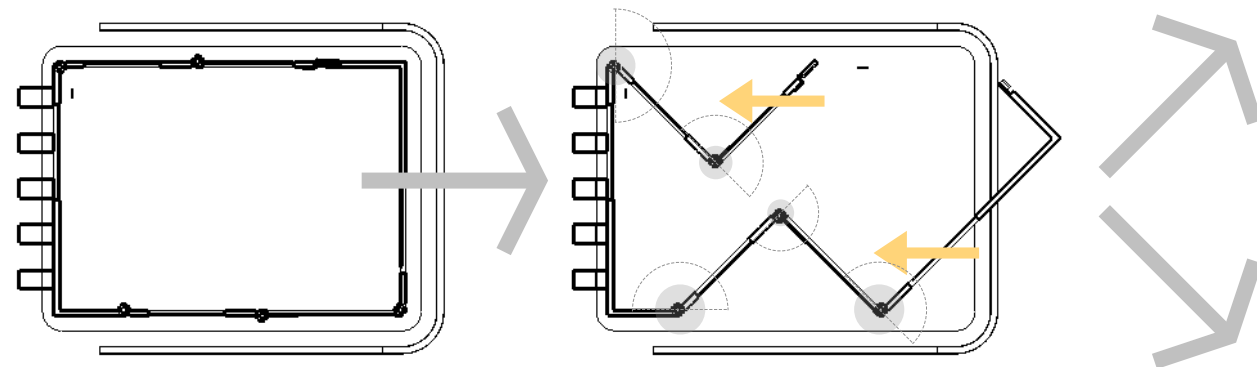

STATIC MODE

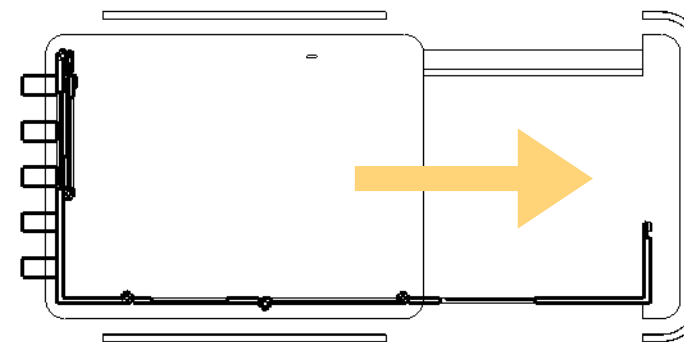

IN OPERATION MODE

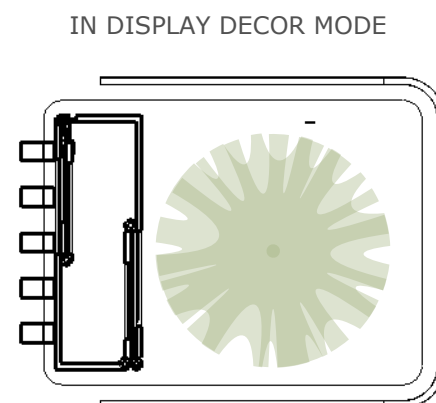

IN DISPLAY DECOR MODE

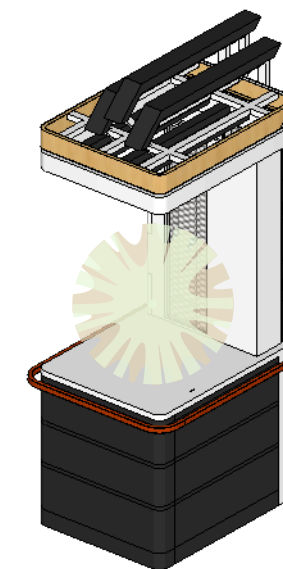
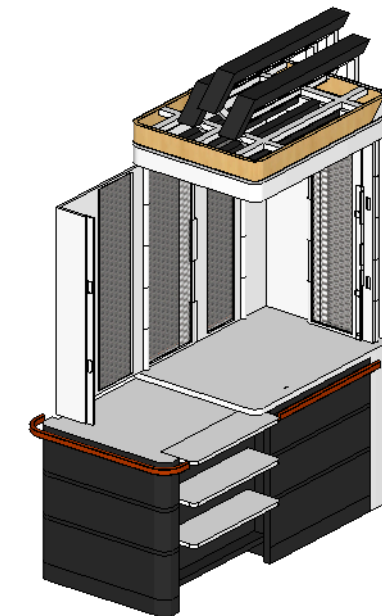

THE COPYRIGHT OF THIS DRAWING REMAINS WITH THE LINK MANAGEMENT LIMITED.
NO PART OF THIS DRAWING MAY BE COPIED OR REPRODUCED IN ANY FORM OR BY ANY MEANS WITHOUT THE WRITTEN CONSENT OF THE LINK MANAGEMENT.

1. ALL DIMENSIONS ARE IN MILLIMETER.
2. ACTUAL DIMENSIONS TO BE CHECKED AND VERIFIED ON SITE.
3. THE CONTENT SHOWN IN THE DRAWINGS ARE FOR DESIGN INTENTION ONLY. THE CONTRACTOR SHOULD SUBMIT ALL NECESSARY INFORMATION INCLUDING SHOP DRAWING, MATERIAL SAMPLES OR CATALOGUES FOR APPROVAL PRIOR ANY CONSTRUCTION WORKS ON SITE.
4. ALL DIMENSIONS SHOWN IN THE DRAWINGS SHOULD BE SUBJECTED TO RE-MEASUREMENT / VERIFY ON SITE BY THE CONTRACTOR. SETTING OUT WORKS SHOULD BE APPROVED BY DESIGNER PRIOR CONSTRUCTION ON SITE.
5. IT IS THE RESPONSIBILITY OF THE CONTRACTOR TO SEEK CONFIRMATION OR CLARIFICATION ON ANY DISCREPANCY FOUND IN THE DRAWINGS / SPECIFICATIONS PRIOR CONSTRUCTION.
6. ALL ALTERNATIVE FINISHING MATERIALS SUBMITTED BY CONTRACTORS MUST BE APPROVED BY PROJECT MANAGER IN WRITING PRIOR TO PURCHASE OF ANY PRODUCTS.

Locking system

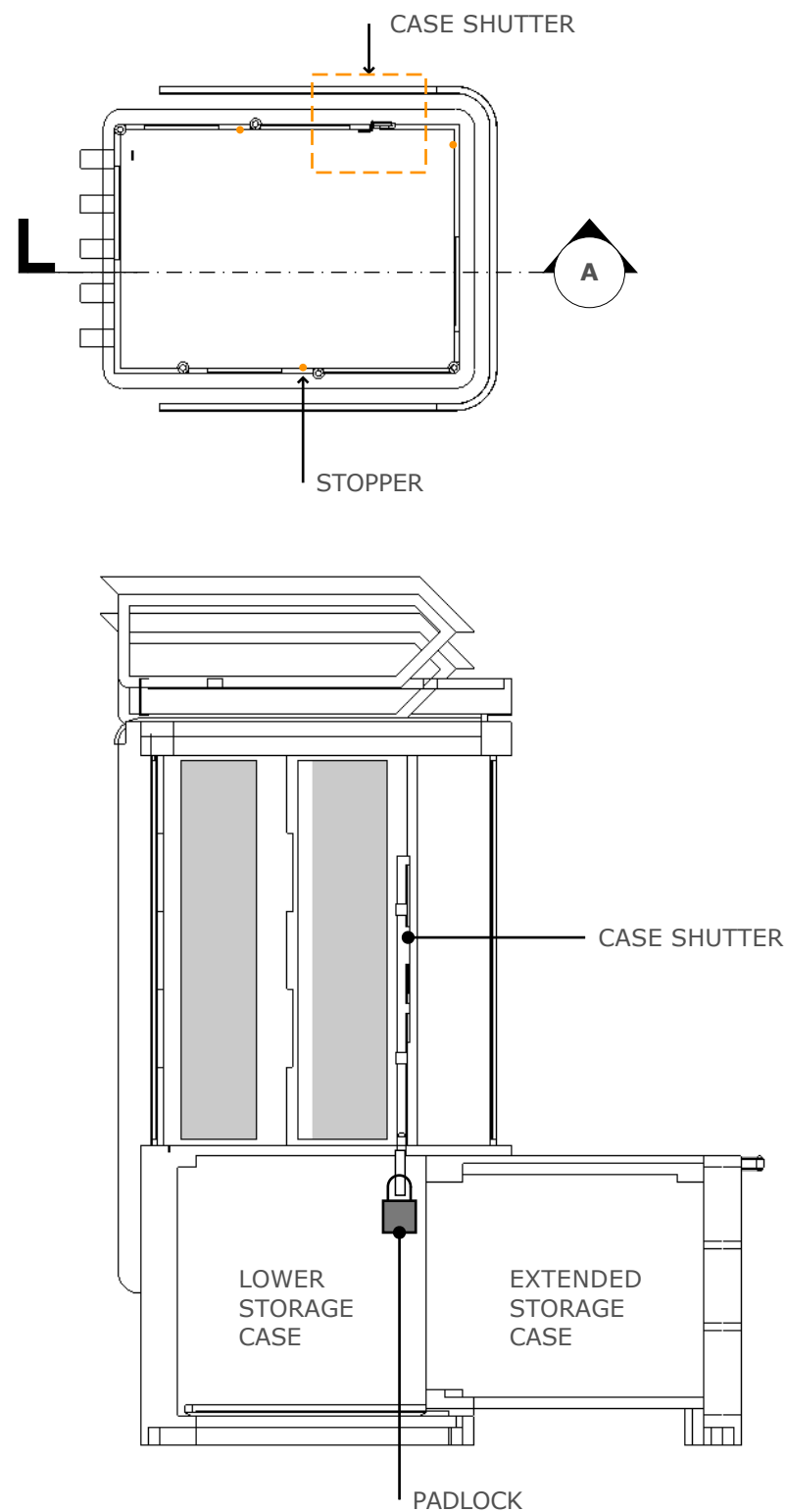

LOCK THE STOPPER TO FIX THE CASE, CLOSE THE FINAL CASE PANEL WITH SHUTTER LOCK; ADD AN PADLOCK IN THE LOWER STORAGE CASE.

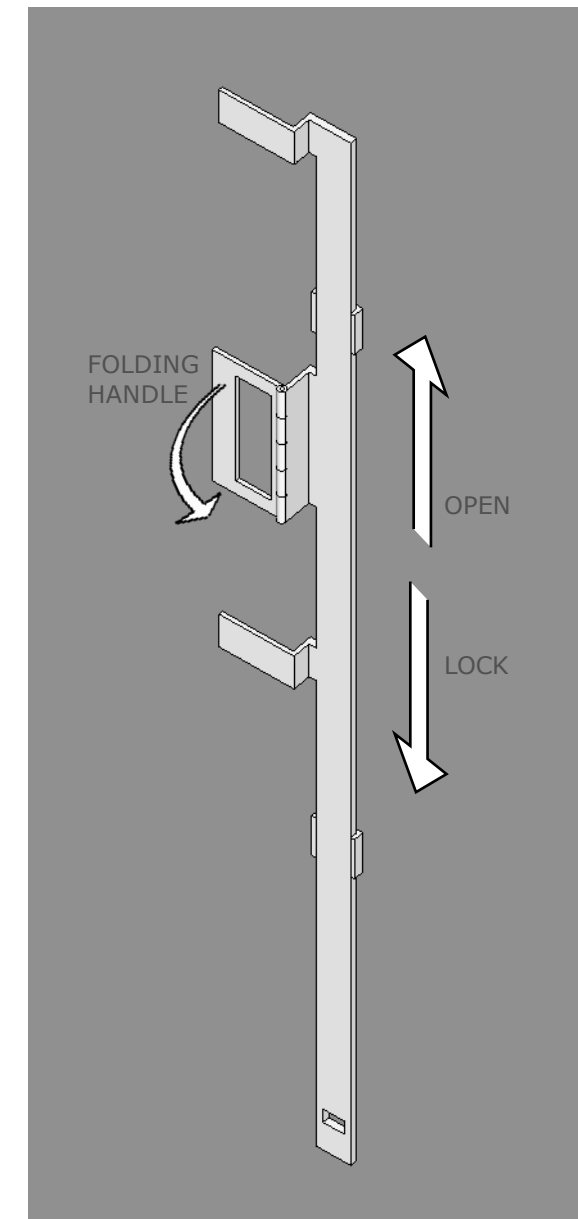
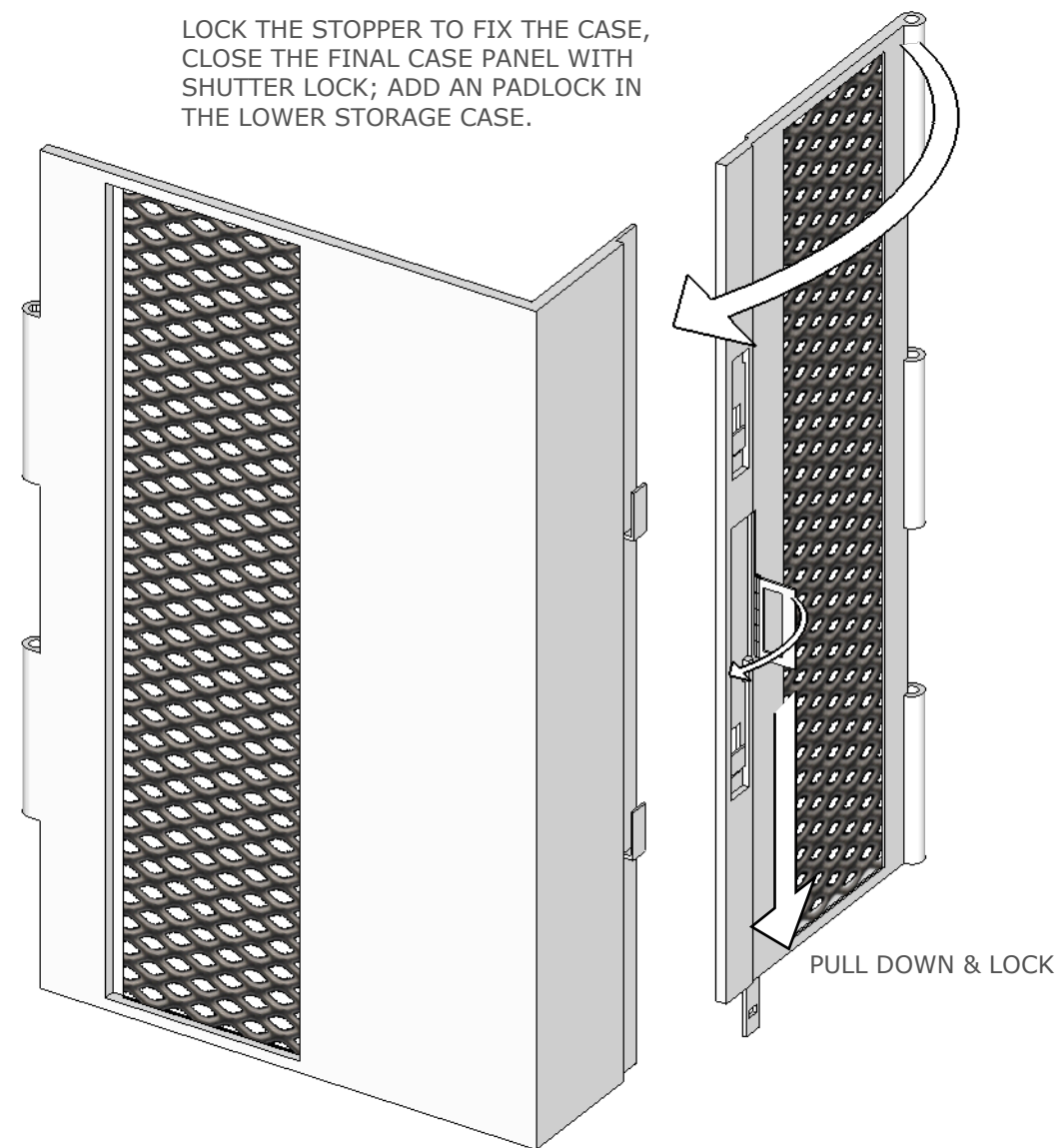

THE COPYRIGHT OF THIS DRAWING REMAINS WITH THE LINK MANAGEMENT LIMITED.
NO PART OF THIS DRAWING MAY BE COPIED OR REPRODUCED IN ANY FORM OR BY ANY MEANS WITHOUT THE WRITTEN CONSENT OF THE LINK MANAGEMENT.

1. ALL DIMENSIONS ARE IN MILLIMETER.
2. ACTUAL DIMENSIONS TO BE CHECKED AND VERIFIED ON SITE.
3. THE CONTENT SHOWN IN THE DRAWINGS ARE FOR DESIGN INTENTION ONLY. THE CONTRACTOR SHOULD SUBMIT ALL NECESSARY INFORMATION INCLUDING SHOP DRAWING, MATERIAL SAMPLES OR CATALOGUES FOR APPROVAL PRIOR ANY CONSTRUCTION WORKS ON SITE.
4. ALL DIMENSIONS SHOWN IN THE DRAWINGS SHOULD BE SUBJECTED TO RE-MEASUREMENT / VERIFY ON SITE BY THE CONTRACTOR. SETTING OUT WORKS SHOULD BE APPROVED BY DESIGNER PRIOR CONSTRUCTION ON SITE.
5. IT IS THE RESPONSIBILITY OF THE CONTRACTOR TO SEEK CONFIRMATION OR CLARIFICATION ON ANY DISCREPANCY FOUND IN THE DRAWINGS / SPECIFICATIONS PRIOR CONSTRUCTION.
6. ALL ALTERNATIVE FINISHING MATERIALS SUBMITTED BY CONTRACTORS MUST BE APPROVED BY PROJECT MANAGER IN WRITING PRIOR TO PURCHASE OF ANY PRODUCTS.

A :: SECTION
scale: 1:20

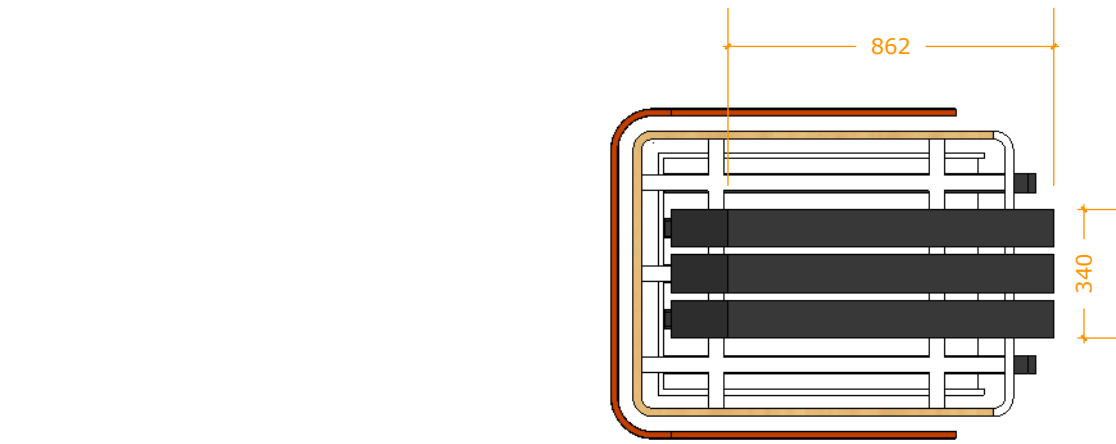

TOP VIEW

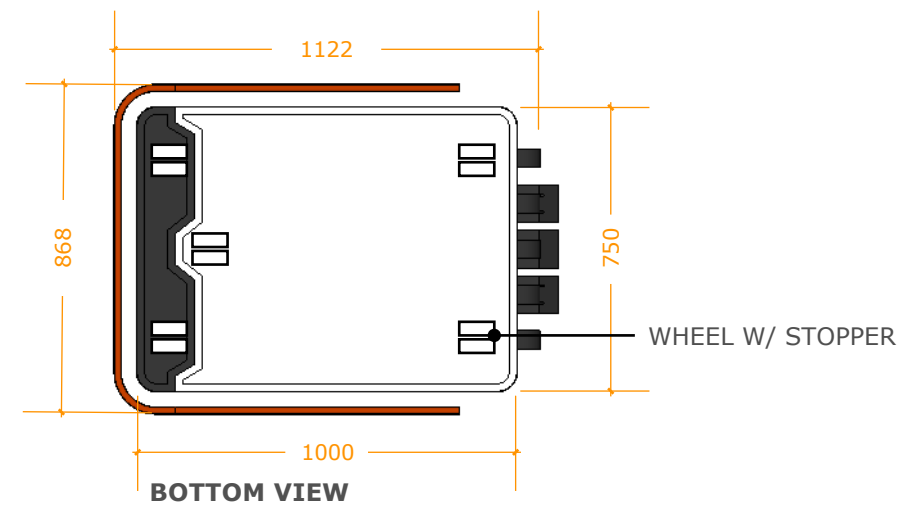

BOTTOM VIEW

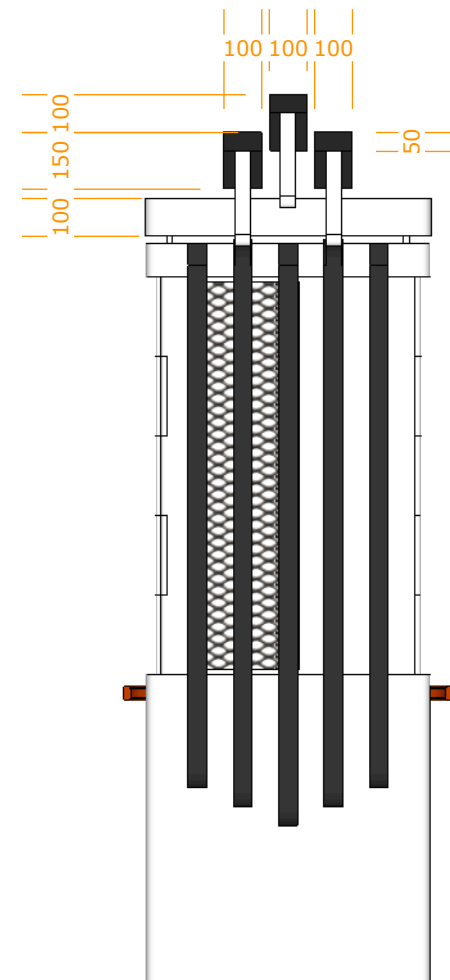

LEFT VIEW

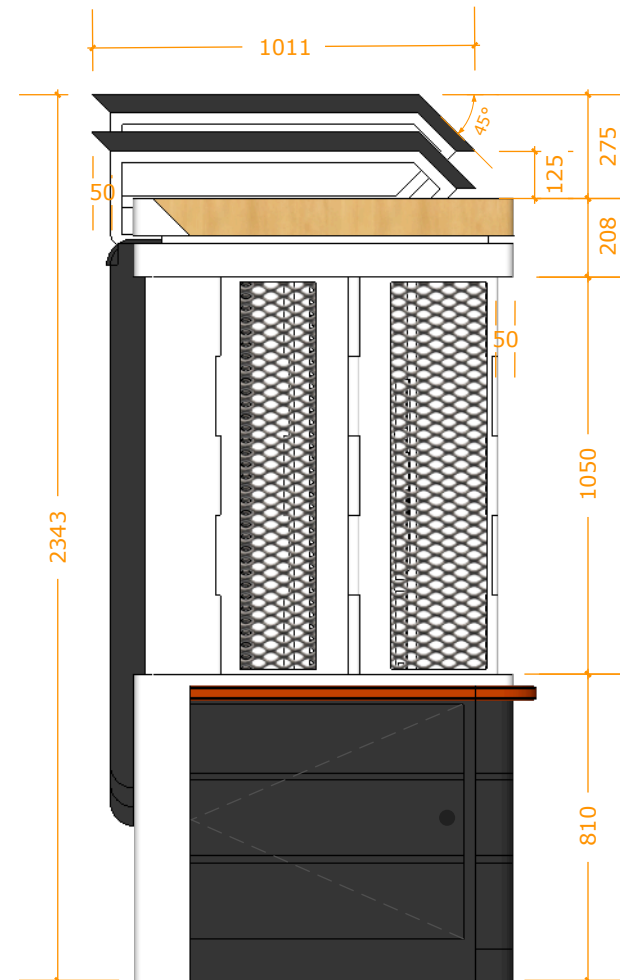

FRONT VIEW

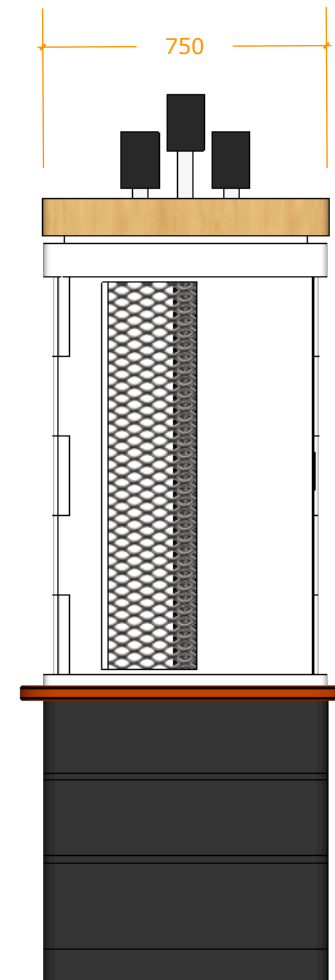

RIGHT VIEW

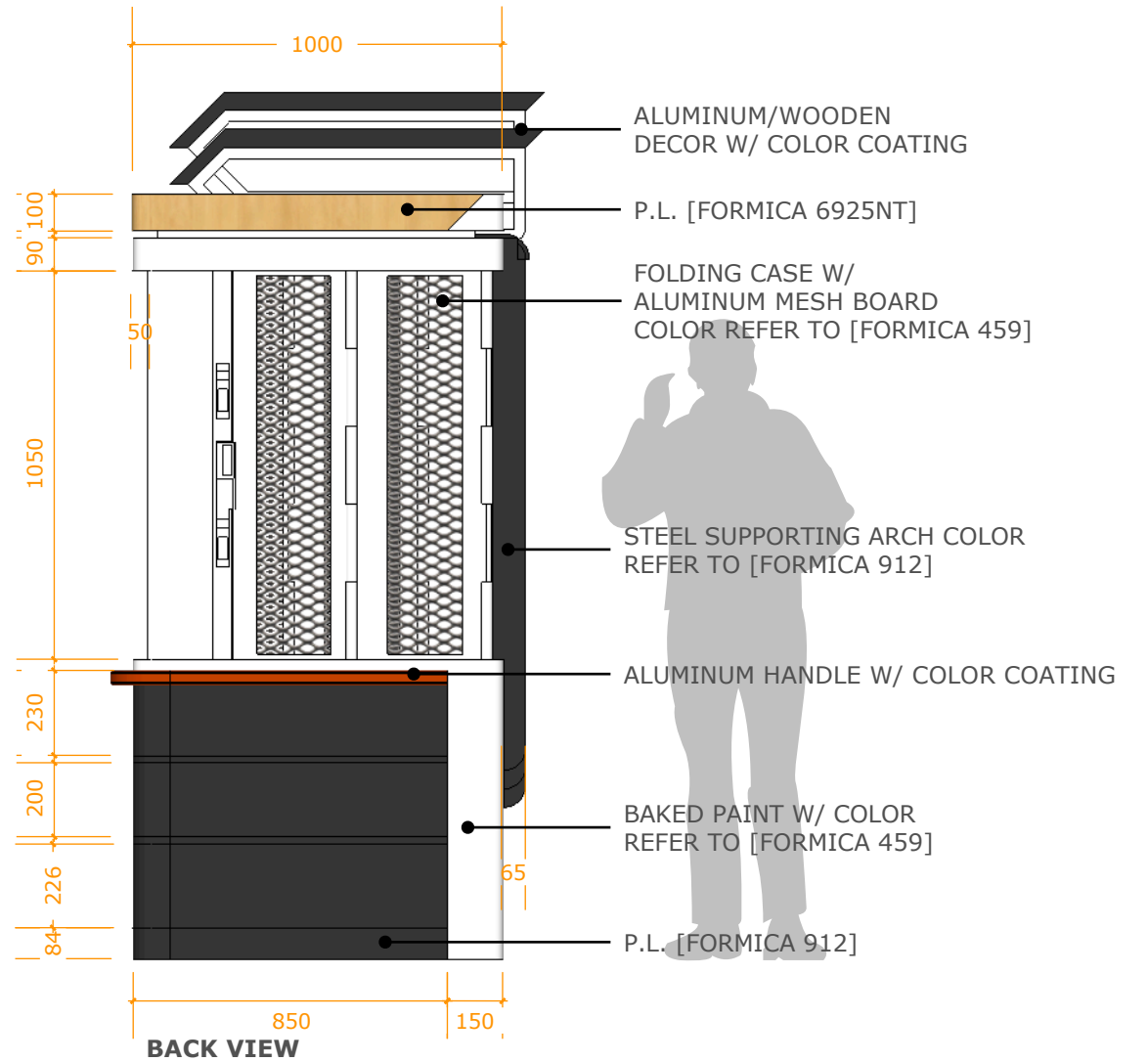

BACK VIEW

THE COPYRIGHT OF THIS DRAWING REMAINS WITH THE LINK MANAGEMENT LIMITED.
NO PART OF THIS DRAWING MAY BE COPIED OR REPRODUCED IN ANY FORM OR BY ANY MEANS WITHOUT THE WRITTEN CONSENT OF THE LINK MANAGEMENT.

1. ALL DIMENSIONS ARE IN MILLIMETER.
2. ACTUAL DIMENSIONS TO BE CHECKED AND VERIFIED ON SITE.
3. THE CONTENT SHOWN IN THE DRAWINGS ARE FOR DESIGN INTENTION ONLY. THE CONTRACTOR SHOULD SUBMIT ALL NECESSARY INFORMATION INCLUDING SHOP DRAWING, MATERIAL SAMPLES OR CATALOGUES FOR APPROVAL PRIOR ANY CONSTRUCTION WORKS ON SITE.
4. ALL DIMENSIONS SHOWN IN THE DRAWINGS SHOULD BE SUBJECTED TO RE-MEASUREMENT / VERIFY ON SITE BY THE CONTRACTOR. SETTING OUT WORKS SHOULD BE APPROVED BY DESIGNER PRIOR CONSTRUCTION ON SITE.
5. IT IS THE RESPONSIBILITY OF THE CONTRACTOR TO SEEK CONFIRMATION OR CLARIFICATION ON ANY DISCREPANCY FOUND IN THE DRAWINGS / SPECIFICATIONS PRIOR CONSTRUCTION.
6. ALL ALTERNATIVE FINISHING MATERIALS SUBMITTED BY CONTRACTORS MUST BE APPROVED BY PROJECT MANAGER IN WRITING PRIOR TO PURCHASE OF ANY PRODUCTS.

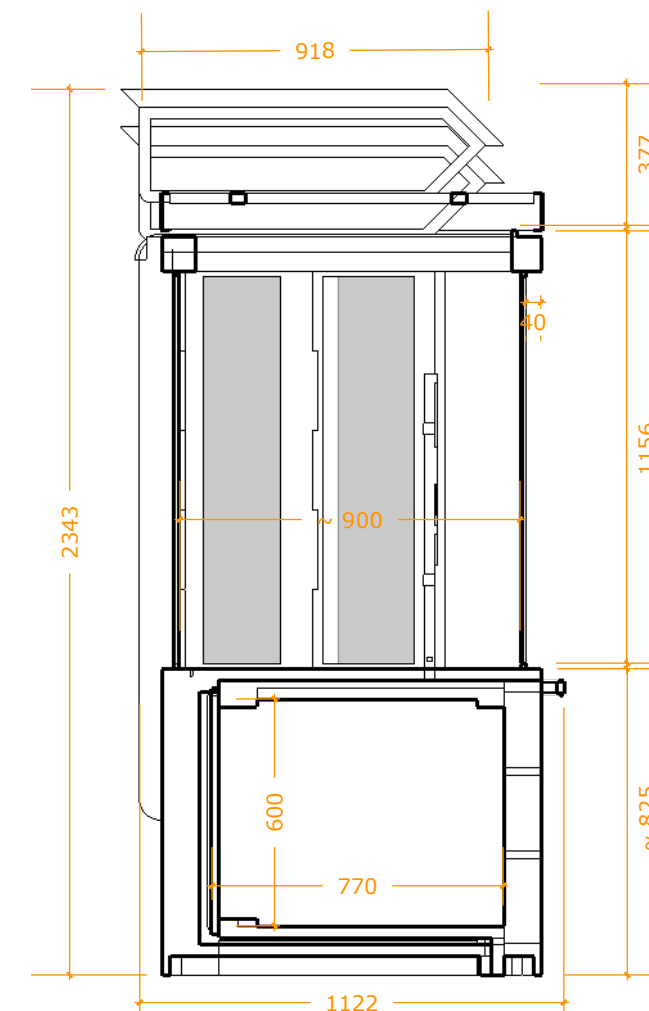
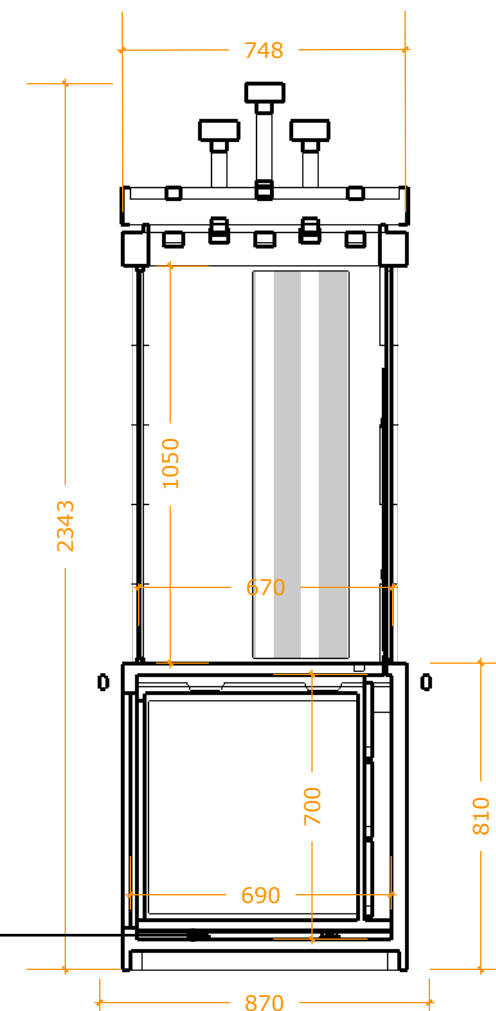
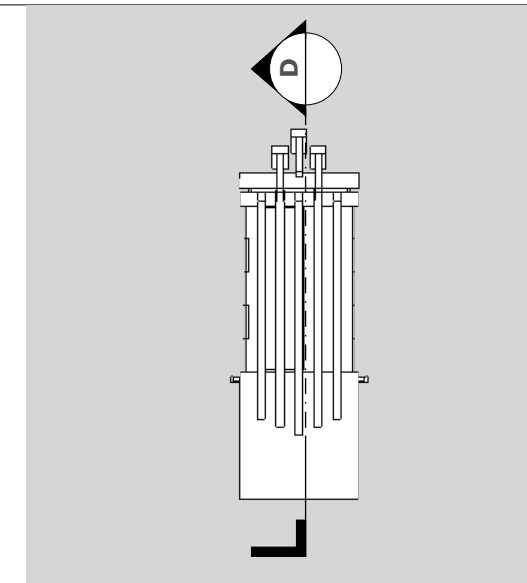
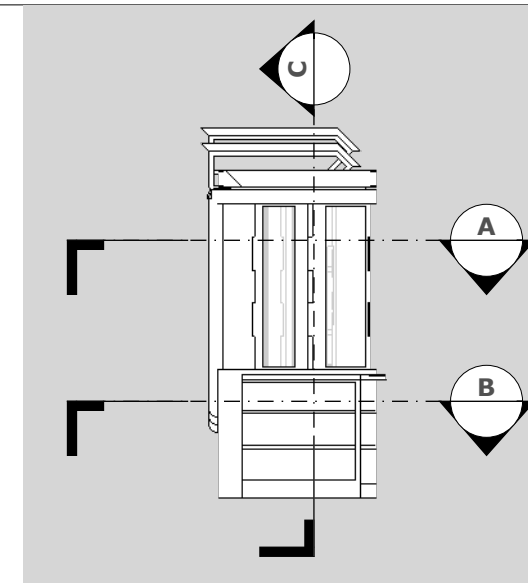

1. ALL DIMENSIONS ARE IN MILLIMETER.
2. ACTUAL DIMENSIONS TO BE CHECKED AND VERIFIED ON SITE.
3. THE CONTENT SHOWN IN THE DRAWINGS ARE FOR DESIGN INTENTION ONLY. THE CONTRACTOR SHOULD SUBMIT ALL NECESSARY INFORMATION INCLUDING SHOP DRAWING, MATERIAL SAMPLES OR CATALOGUES FOR APPROVAL PRIOR ANY CONSTRUCTION WORKS ON SITE.
4. ALL DIMENSIONS SHOWN IN THE DRAWINGS SHOULD BE SUBJECTED TO RE-MEASUREMENT / VERIFY ON SITE BY THE CONTRACTOR. SETTING OUT WORKS SHOULD BE APPROVED BY DESIGNER PRIOR CONSTRUCTION ON SITE.
5. IT IS THE RESPONSIBILITY OF THE CONTRACTOR TO SEEK CONFIRMATION OR CLARIFICATION ON ANY DISCREPANCY FOUND IN THE DRAWINGS / SPECIFICATIONS PRIOR CONSTRUCTION.
6. ALL ALTERNATIVE FINISHING MATERIALS SUBMITTED BY CONTRACTORS MUST BE APPROVED BY PROJECT MANAGER IN WRITING PRIOR TO PURCHASE OF ANY PRODUCTS.



OPERATION MODE

THE COPYRIGHT OF THIS DRAWING REMAINS WITH THE LINK MANAGEMENT LIMITED.
NO PART OF THIS DRAWING MAY BE COPIED OR REPRODUCED IN ANY FORM OR BY ANY MEANS WITHOUT THE WRITTEN CONSENT OF THE LINK MANAGEMENT.

1. ALL DIMENSIONS ARE IN MILLIMETER.
2. ACTUAL DIMENSIONS TO BE CHECKED AND VERIFIED ON SITE.
3. THE CONTENT SHOWN IN THE DRAWINGS ARE FOR DESIGN INTENTION ONLY. THE CONTRACTOR SHOULD SUBMIT ALL NECESSARY INFORMATION INCLUDING SHOP DRAWING, MATERIAL SAMPLES OR CATALOGUES FOR APPROVAL PRIOR ANY CONSTRUCTION WORKS ON SITE.
4. ALL DIMENSIONS SHOWN IN THE DRAWINGS SHOULD BE SUBJECTED TO RE-MEASUREMENT / VERIFY ON SITE BY THE CONTRACTOR. SETTING OUT WORKS SHOULD BE APPROVED BY DESIGNER PRIOR CONSTRUCTION ON SITE.
5. IT IS THE RESPONSIBILITY OF THE CONTRACTOR TO SEEK CONFIRMATION OR CLARIFICATION ON ANY DISCREPANCY FOUND IN THE DRAWINGS / SPECIFICATIONS PRIOR CONSTRUCTION.
6. ALL ALTERNATIVE FINISHING MATERIALS SUBMITTED BY CONTRACTORS MUST BE APPROVED BY PROJECT MANAGER IN WRITING PRIOR TO PURCHASE OF ANY PRODUCTS.

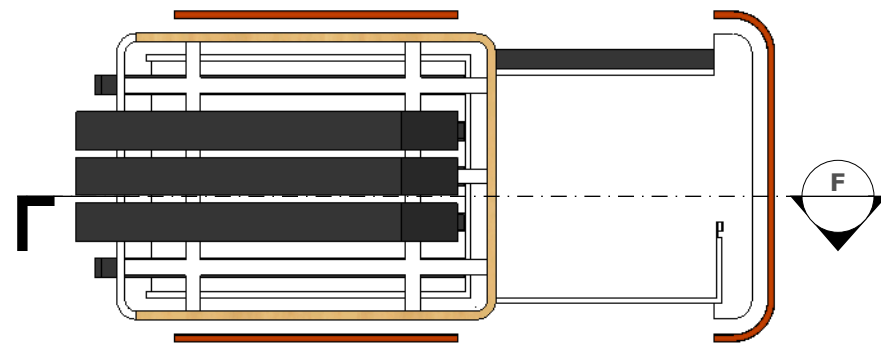

A :: TOP VIEW
scale: 1:20

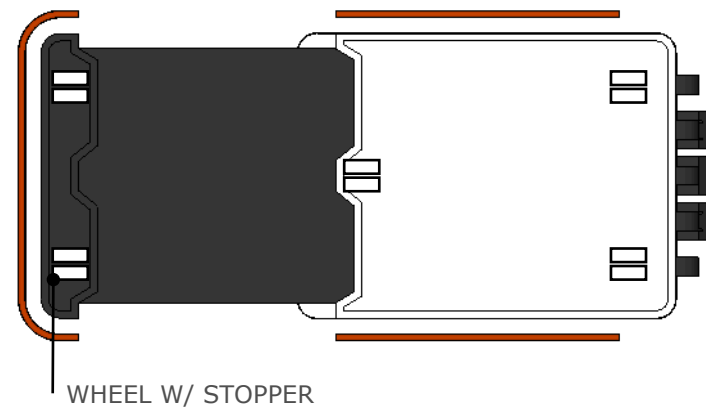

B :: BOTTOM VIEW
scale: 1:20

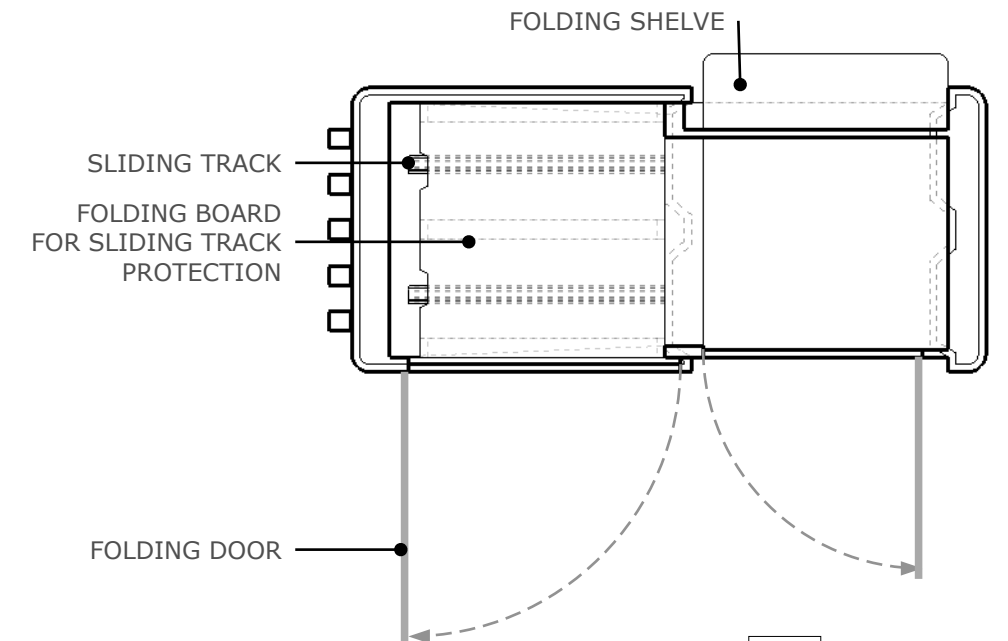

E :: SECTION
scale: 1:20

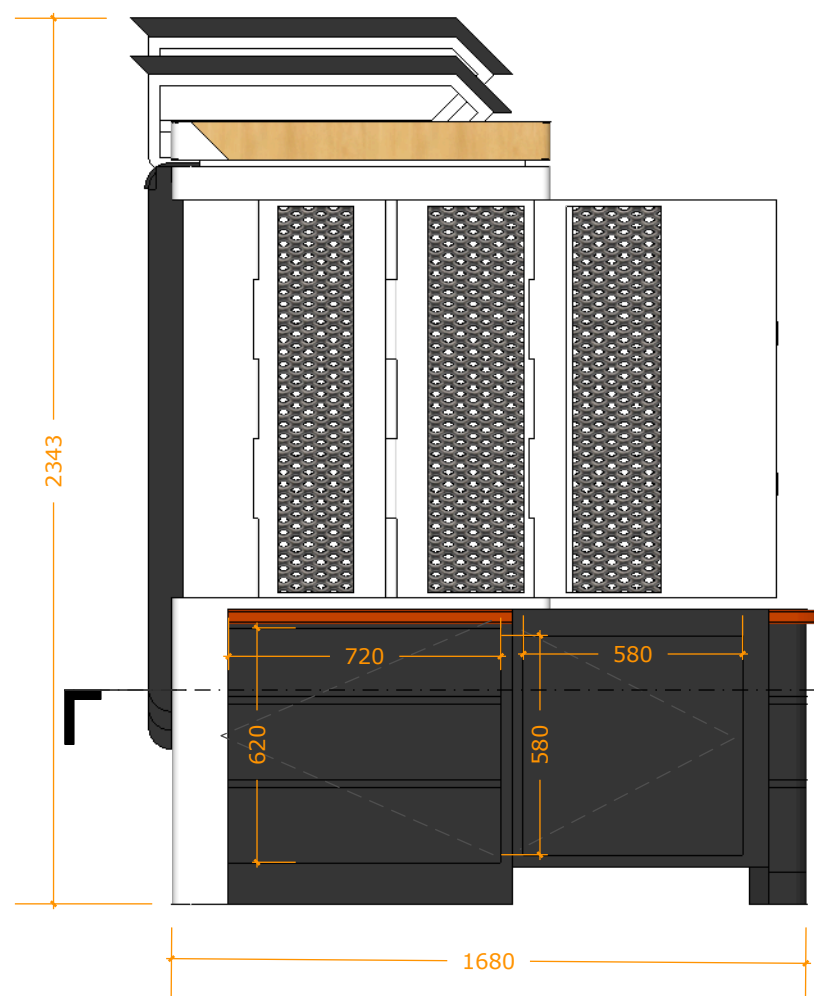

C :: FRONT ELEVATION
scale: 1:20

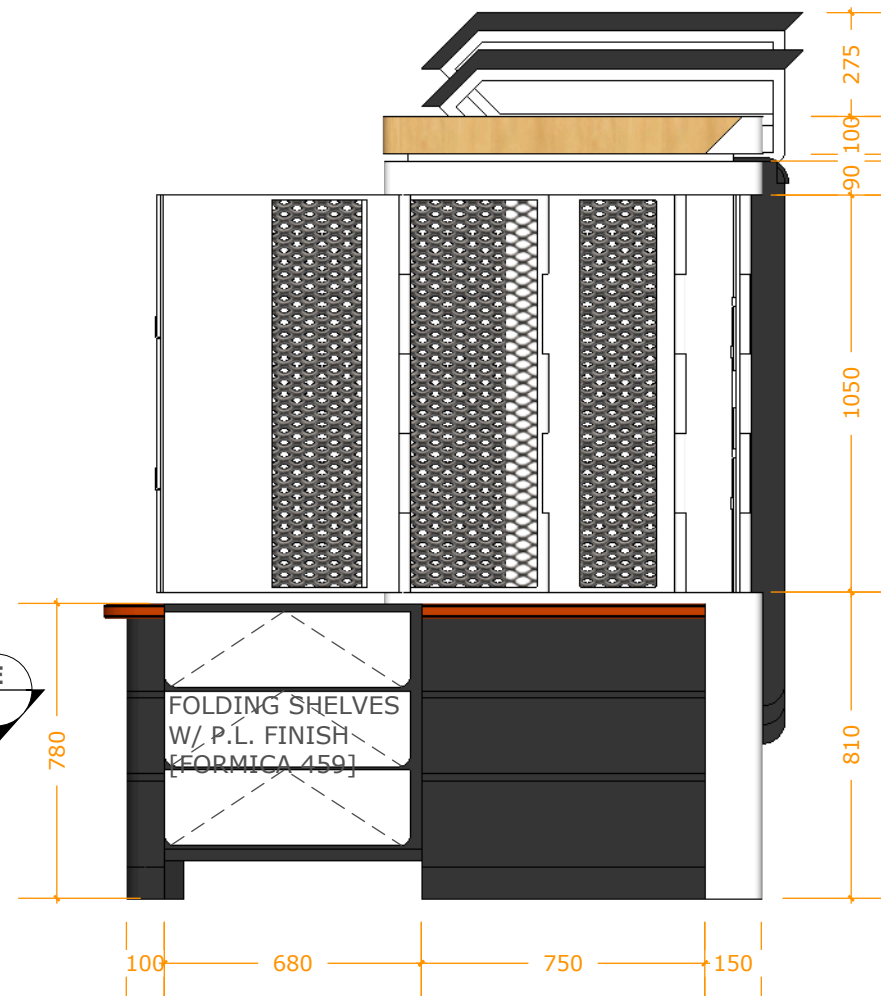

D :: BACK ELEVATION
scale: 1:20

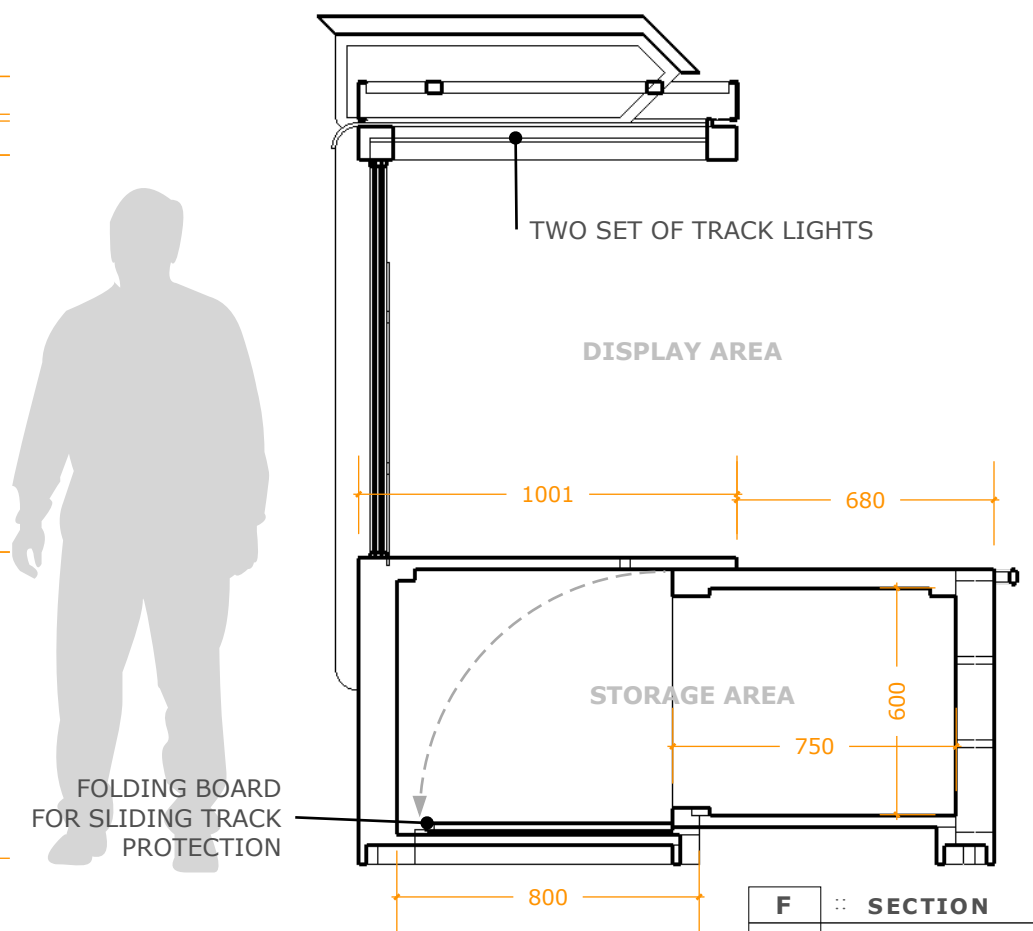

F :: SECTION
scale: 1:20

THE COPYRIGHT OF THIS DRAWING REMAINS WITH THE LINK MANAGEMENT LIMITED.
NO PART OF THIS DRAWING MAY BE COPIED OR REPRODUCED IN ANY FORM OR BY ANY MEANS WITHOUT THE WRITTEN CONSENT OF THE LINK MANAGEMENT.

1. ALL DIMENSIONS ARE IN MILLIMETER.
2. ACTUAL DIMENSIONS TO BE CHECKED AND VERIFIED ON SITE.
3. THE CONTENT SHOWN IN THE DRAWINGS ARE FOR DESIGN INTENTION ONLY. THE CONTRACTOR SHOULD SUBMIT ALL NECESSARY INFORMATION INCLUDING SHOP DRAWING, MATERIAL SAMPLES OR CATALOGUES FOR APPROVAL PRIOR ANY CONSTRUCTION WORKS ON SITE.
4. ALL DIMENSIONS SHOWN IN THE DRAWINGS SHOULD BE SUBJECTED TO RE-MEASUREMENT / VERIFY ON SITE BY THE CONTRACTOR. SETTING OUT WORKS SHOULD BE APPROVED BY DESIGNER PRIOR CONSTRUCTION ON SITE.
5. IT IS THE RESPONSIBILITY OF THE CONTRACTOR TO SEEK CONFIRMATION OR CLARIFICATION ON ANY DISCREPANCY FOUND IN THE DRAWINGS / SPECIFICATIONS PRIOR CONSTRUCTION.
6. ALL ALTERNATIVE FINISHING MATERIALS SUBMITTED BY CONTRACTORS MUST BE APPROVED BY PROJECT MANAGER IN WRITING PRIOR TO PURCHASE OF ANY PRODUCTS.